

ERECTED 1922.
 TYPE. FRAME.
 FOUNDATION CONCRETE
 WALLS. 2x6"
 ROOF { TYPE. GABLE SIDING
 DITCH. 1/3.
 HEATING. STOVES.

FLOOR. 7/8" & 2" SHIPLAP
 FINISH. { INSIDE. 3/4" BD. CEILING.
 OUTSIDE.
 CEILING HEIGHTS 12'-0" - 12'-8" FRT.
 LIGHTING.
 SANITARY FACILITIES. OUTSIDE TOILETS.

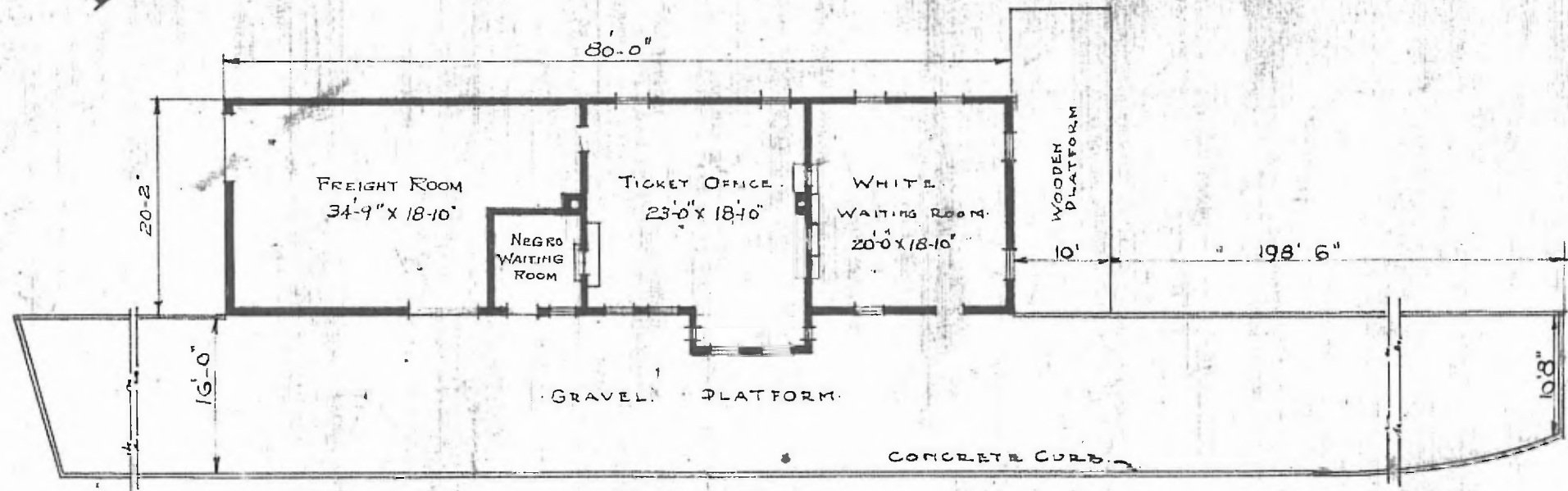

FLOOR PLAN
SCALE 1/16" = 1'-0"

COMBINATION STATION AT
 FRANCIS OKLA.

REVISED 10-11-21
 SEPT. 22, 1911