

14

ERECTED 1900.  
 TYPE FRAME.  
 FOUNDATION PILE HEADS.  
 WALLS 2' x 6"  
 ROOF TYPE GABLE. SHINGLES.  
 PITCH 1/3  
 HEATING STOVES.

FLOOR 3 1/4" Y. PINE  
 FINISH { INSIDE 3 1/2" BD. CEILING.  
 OUTSIDE BOARD & BATTS.  
 CEILING HEIGHT 11' 8" FRT. 13' 3"  
 LIGHTING LAMPS.  
 SANITARY FACILITIES OUTSIDE TOILET.

E-39

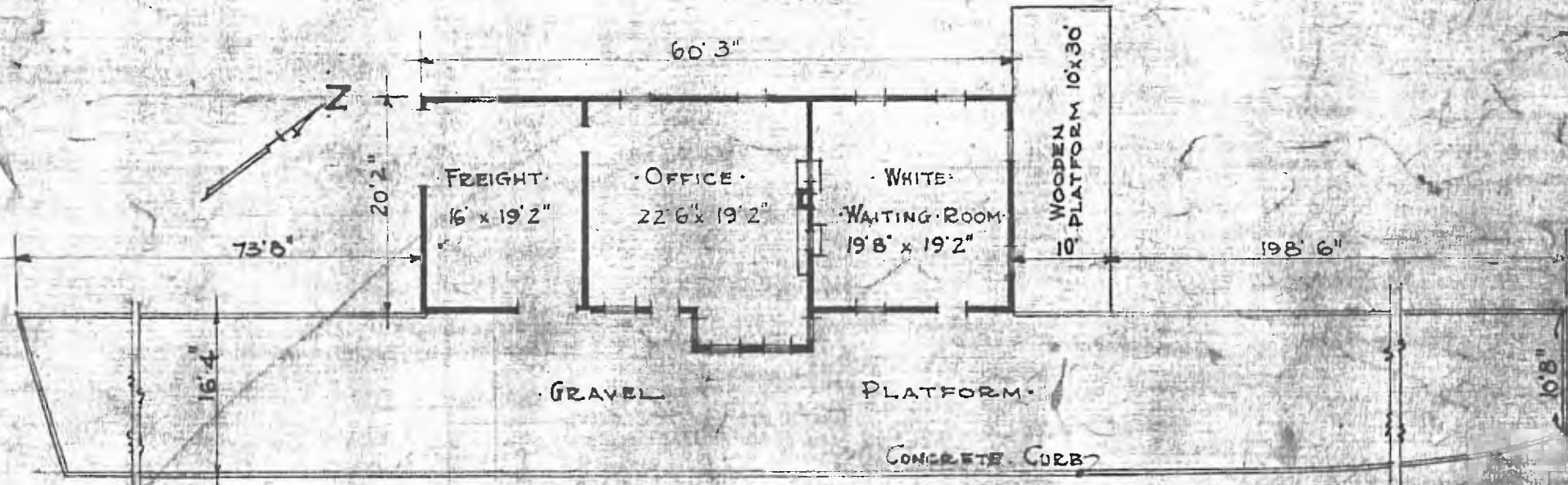

FLOOR PLAN  
 SCALE 1/16" = 1' 0"

COMBINATION STATION AT  
 FRANCIS OKLA.

SEPT. 27. 1915.