

56.

ERECTED 1904.  
 TYPE FRAME.  
 FOUNDATION PILE HEADS.  
 WALLS 2x6 STUDS.  
 ROOF { TYPE GABLE - SHINGLES.  
       PITCH APPROX. 1/3 PITCH.  
 HEATING STOVES.

FLOOR 2x3 1/2 YELLOW PINE.  
 FINISH { INSIDE 1/2 x 3/4 PL. CEILING.  
           OUTSIDE BOARDS & BATTS - 1" x 6" DROP SIDING.  
 CEILING HEIGHTS 11'0" WAITING ROOMS, T.O.; F.E.B. ROOMS.  
 LIGHTING OIL LAMPS.  
 SANITARY FACILITIES OUTSIDE TOILETS.

*W. W. W. W.*  
*2563*

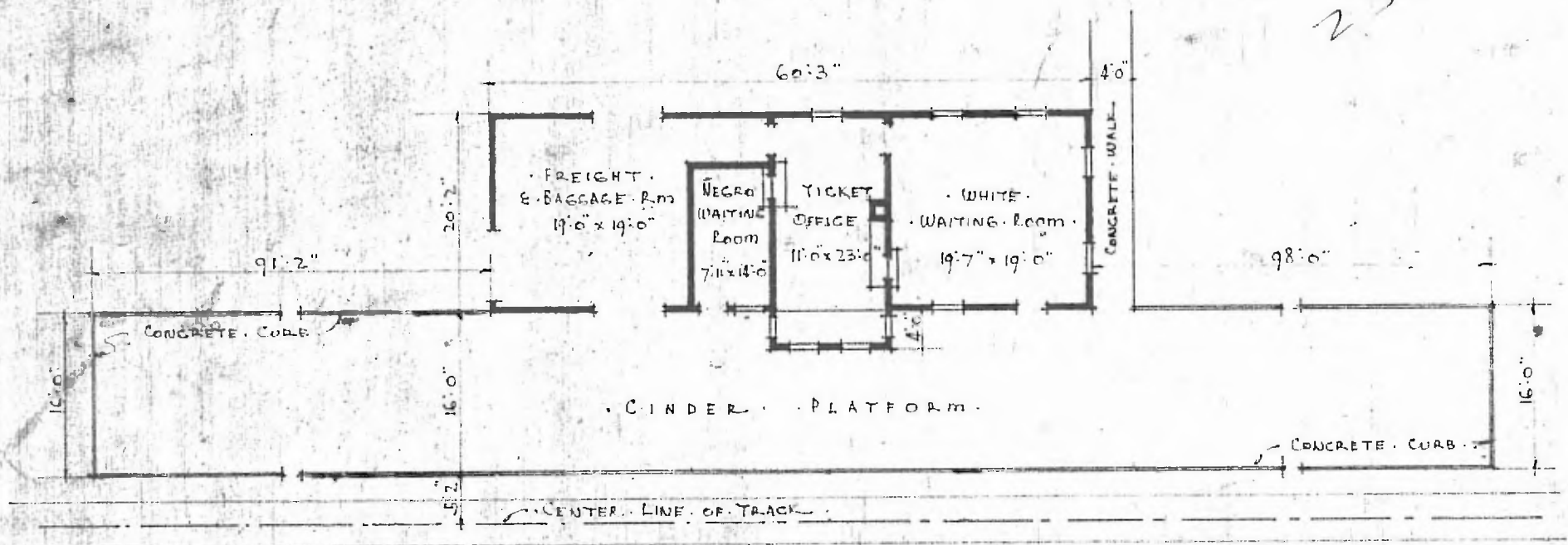

FLOOR PLAN  
 SCALE 1/16" = 1'0"

COMBINATION STATION AT  
 GOLTRY - OKLA.



JULY 5, 1917.