

ERECTED: 1900.
 TYPE: FRAME.
 FOUNDATION: PILE HEADS.
 WALLS: 2' x 6"
 ROOF TYPE: GABLE SHINGLES.
 ROOF PITCH: 1/3
 HEATING: STOVES.

FLOOR: 3 1/2" Y. PINE.
 FINISH { INSIDE: BD. CEILING.
 OUTSIDE: BOARD & BATTIS.
 CEILING HEIGHT: 11' 9" FET. 15' 3"
 LIGHTING: LAMPS.
 SANITARY FACILITIES: OUTSIDE TOILETS.

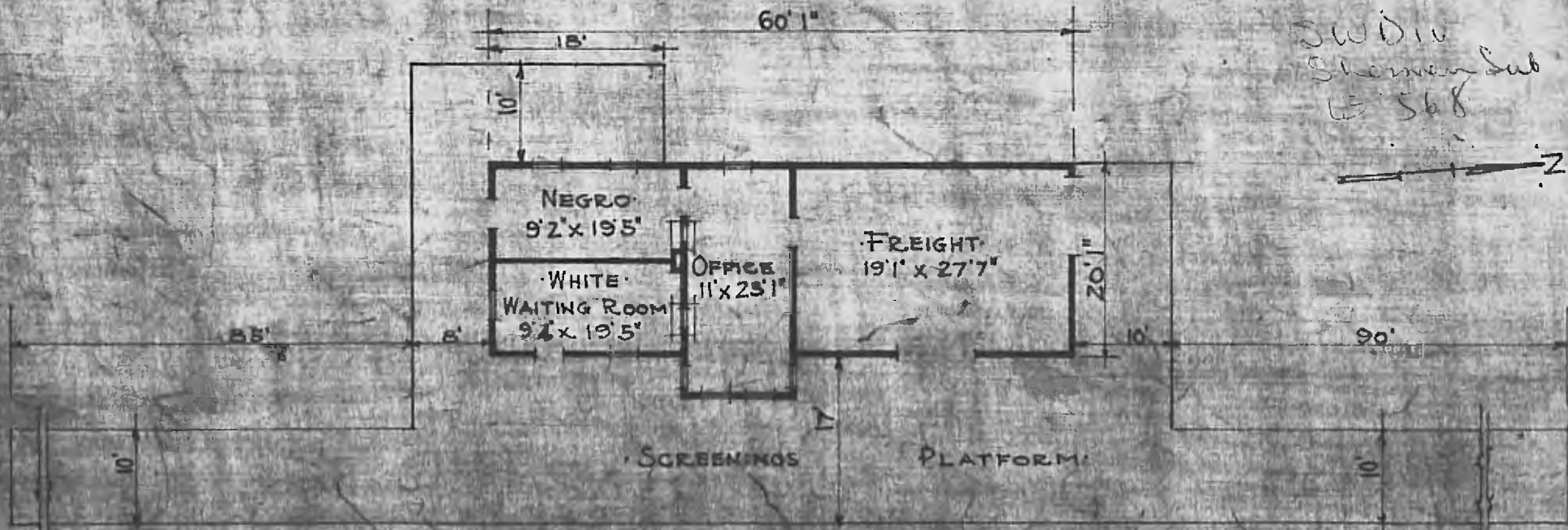

SWD in
 Sherman Sub
 W 568

FLOOR PLAN
 SCALE 1/16"

COMBINATION STATION AT
 HICKORY OKLA.