

ERECTED - 1910.
 TYPE - FRAME.
 FOUNDATION - CONCRETE.
 WALLS - 2x6" STUDS.
 ROOF - { TYPE - STANDARD - SHINGLES.
 PITCH - STANDARD.
 HEATING - STOVES.

FLOOR - 2 1/4" MAPLE.
 FINISH - { INSIDE - V-JOINT CEILING.
 OUTSIDE - STANDARD.
 CEILING HEIGHTS - STANDARD.
 LIGHTING - OIL LAMPS.
 SANITARY FACILITIES - OUTSIDE TOILETS.

61.

Wichita
Award

2595

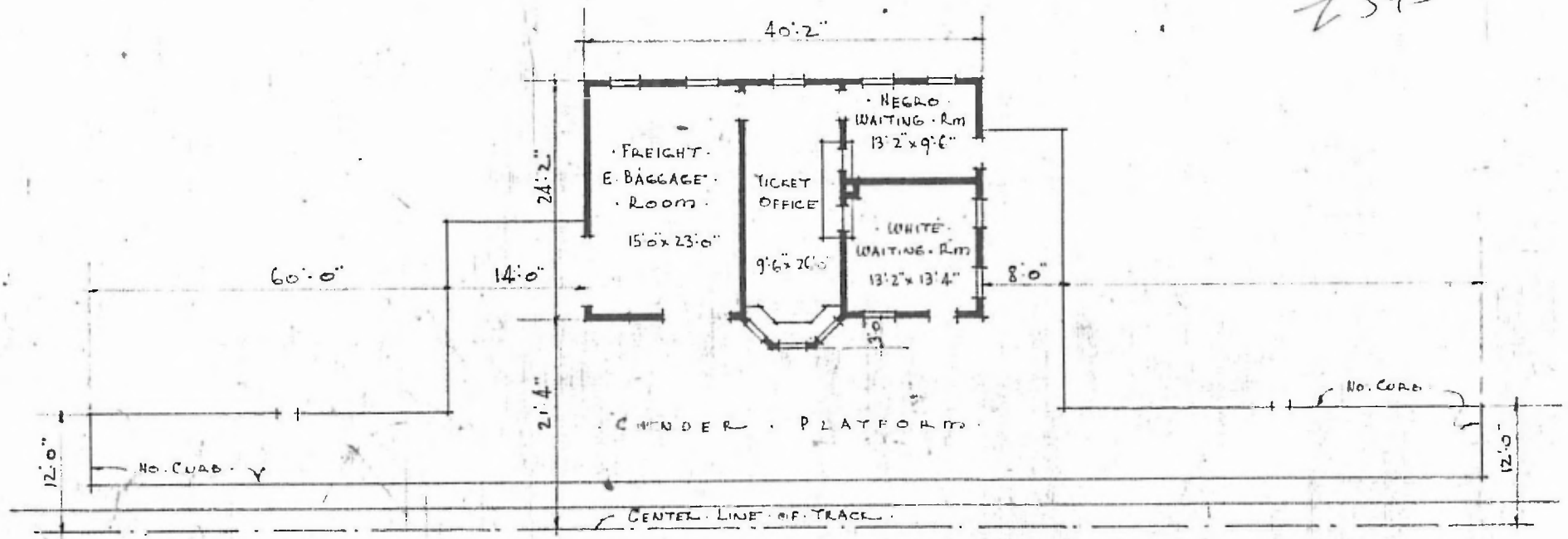

FLOOR PLAN
 SCALE 1/16" = 1'0"

COMBINATION STATION - AT -
 HOPETON - OKLA



JULY 7 1917.