

ERECTED: 1900.  
 TYPE: FRAME.  
 FOUNDATION: BLOCKS.  
 WALLS: 2" x 6"  
 ROOF { TYPE: GABLE SHINGLES.  
 PITCH: 1/3  
 HEATING: STOVES.

FLOOR: 3/4" x 3 1/4" Y. PINE.  
 FINISH { INSIDE: 3/4" x 3 1/4" BI. CEILING.  
 OUTSIDE: BOARD & BATTS.  
 CEILING HEIGHT: 12' 3"  
 LIGHTING: LAMPS.  
 SANITARY FACILITIES: OUTSIDE TOILET.

SW DIV  
 Sherman Sub  
 E 610

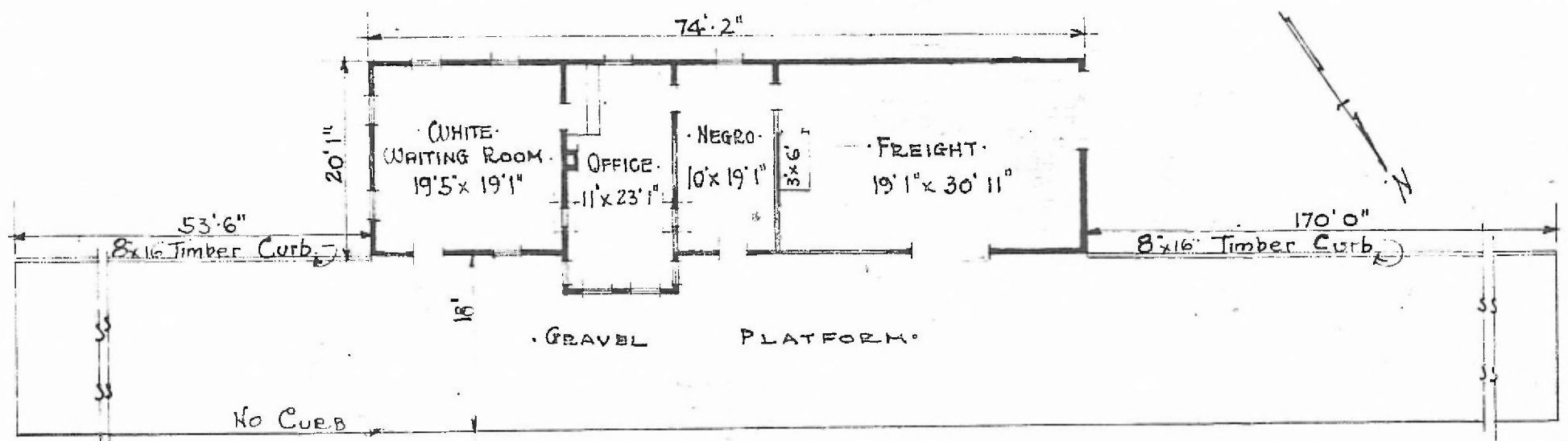

FLOOR PLAN.  
 SCALE: 1/16" = 1' 0"

COMBINATION STATION AT  
 KINGSTON OKLA.

OCT. 25. 1915.