

SW - DIV. RED RIVER  
SUB-DIV. SPERMAD  
STA. No. E 610

ERECTED 1900  
 TYPE FRAME  
 FOUNDATION BLOCKS  
 WALLS 2" x 6"  
 ROOF { TYPE GABLE - SHINGLES  
       PITCH 1/3  
 HEATING STOVES

FLOOR 3/4" x 3 1/2" Y.P.  
 FINISH { INSIDE 3/4" x 3 1/2" Bd. CEILING  
        OUTSIDE BOARD & BATT'S  
 CEILING HEIGHT 12'-3"  
 LIGHTING LAMPS  
 SANITARY FACILITIES. OUTSIDE TOILETS

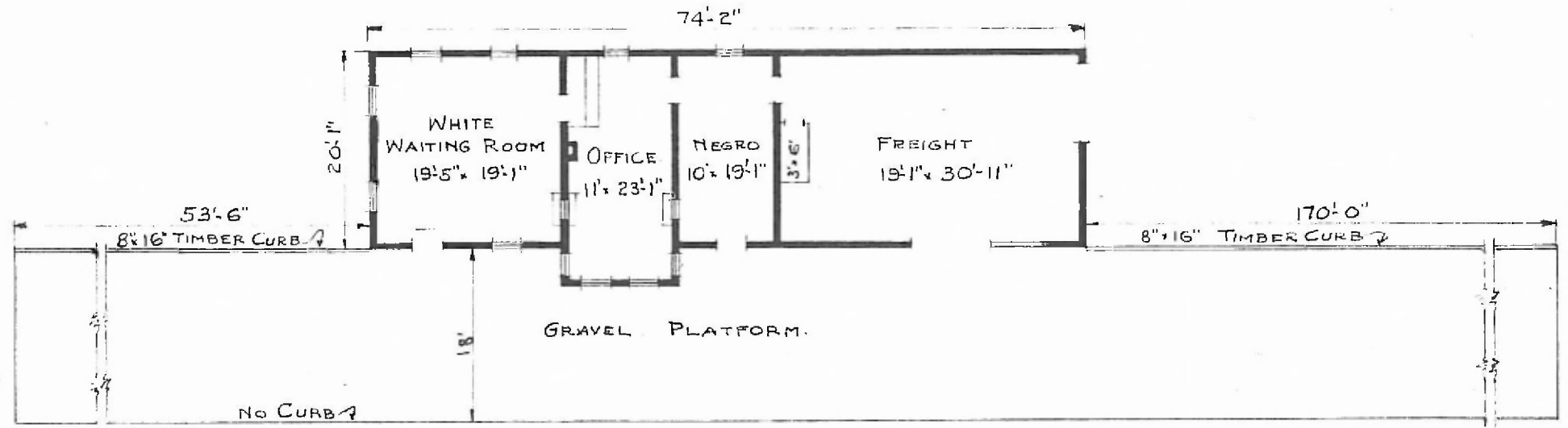

FLOOR PLAN  
 SCALE 1/16" = 1'-0"



COMBINATION STATION AT  
 KINGSTON. OKLA.

Oct. 25, 1915