

·ERECTED· 1899
 ·TYPE· FRAME
 ·FOUNDATION· PILE HEADS
 ·WALLS· 2"x6"
 ·ROOF· (TYPE· CABLE, SHINGLES.
 PITCH· 3
 ·HEATING· SI STOVES

·FLOOR· 3/4" x 3/4" Y.P.
 FINISH (INSIDE· 3/4" x 3/4" M. & B.
 OUTSIDE· BOARDS & BATTENS
 ·CEILING HEIGHT· 11'-3"
 ·LIGHTING· OIL LAMPS
 ·SANITARY FACILITIES· OUTSIDE TOILETS.

DIV. SOUTHWESTERN
 SUB. DIV. OKLAHOMA
 STA. No. G 515

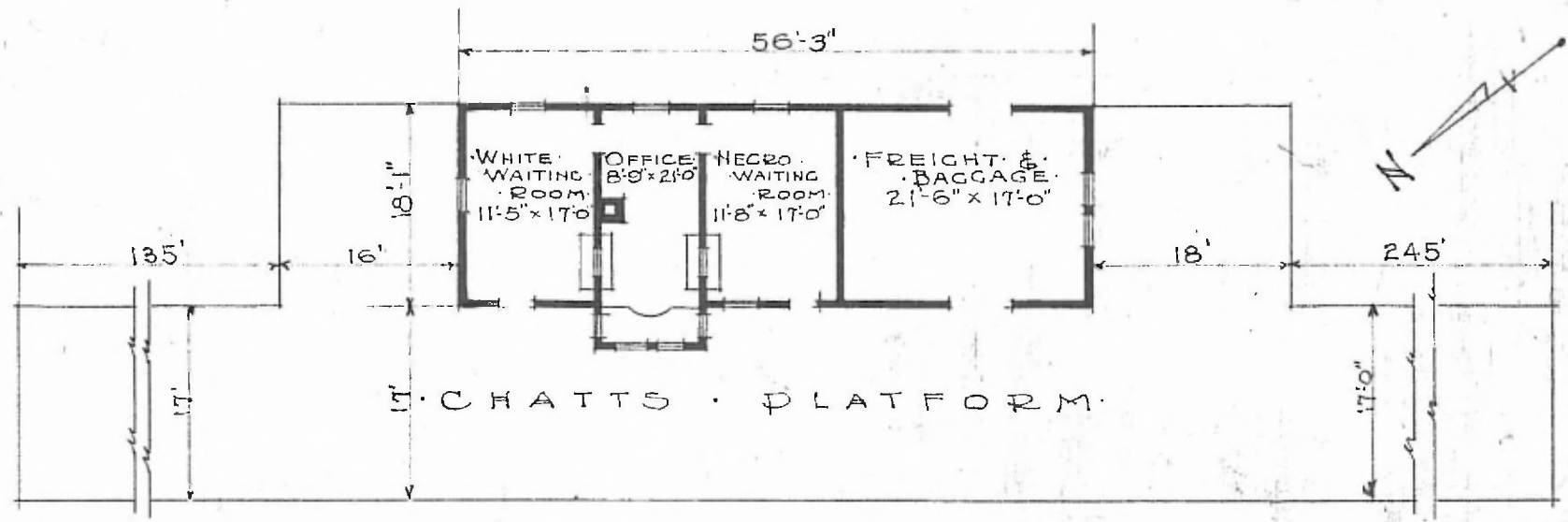

·FLOOR PLAN·
 SCALE 1/16" = 1'-0"

·COMBINATION STATION·
 ·LUTHER OKLA·

JULY 18, 1916.