

ERECTED. 1894.
 TYPE. FRAME.
 FOUNDATION. PILE HEADS.
 WALLS. 2x6 STUDS.
 ROOF. { TYPE GABLE SHINGLES.
 PITCH. 4
 HEATING. STOVES.

FLOOR. 8x3 1/2" Y.P.
 FINISH. { INSIDE. 7/8 x 3 1/4" W.P.
 OUTSIDE. 1" x 12" BOARDS & BATTS.
 CEILING HEIGHT. 11-5 1/2' FRT. 11-5 1/2' & 10-7 1/2'
 LIGHTING. ELECTRIC. 2 WIRE. 110 AC.
 SANITARY FACILITIES. INSIDE TOILET.

Northern Div
After Sub
 473

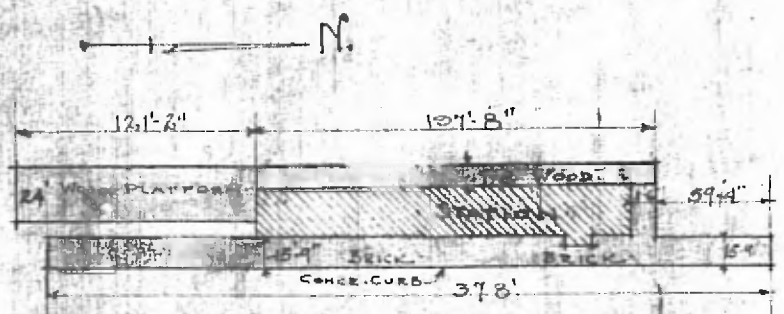
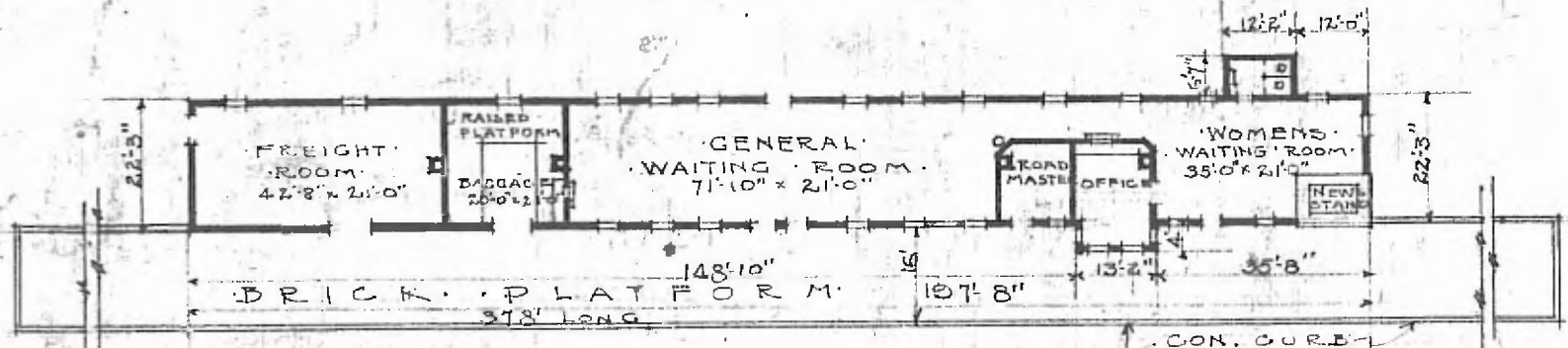

COMBINATION STATION
 MIAMI OKLA.

NOV. 7, 1919