

ERECTED 1900.
 TYPE FRAME
 FOUNDATION PILE HEADS
 WALLS 2x6"
 ROOF TYPE GABLE SHINGLES
 PITCH 1/3
 HEATING STOVES

FLOOR 3 1/4" Y. PINE
 FINISH INSIDE 3 1/4" BD. CEILING
 OUTSIDE BOARD & BATTIS
 CEILING HEIGHT 12'3"
 LIGHTING LAMPS
 SANITARY FACILITIES OUTSIDE TOILETS

S.W. DIV
 Sherman Sub
 E-580

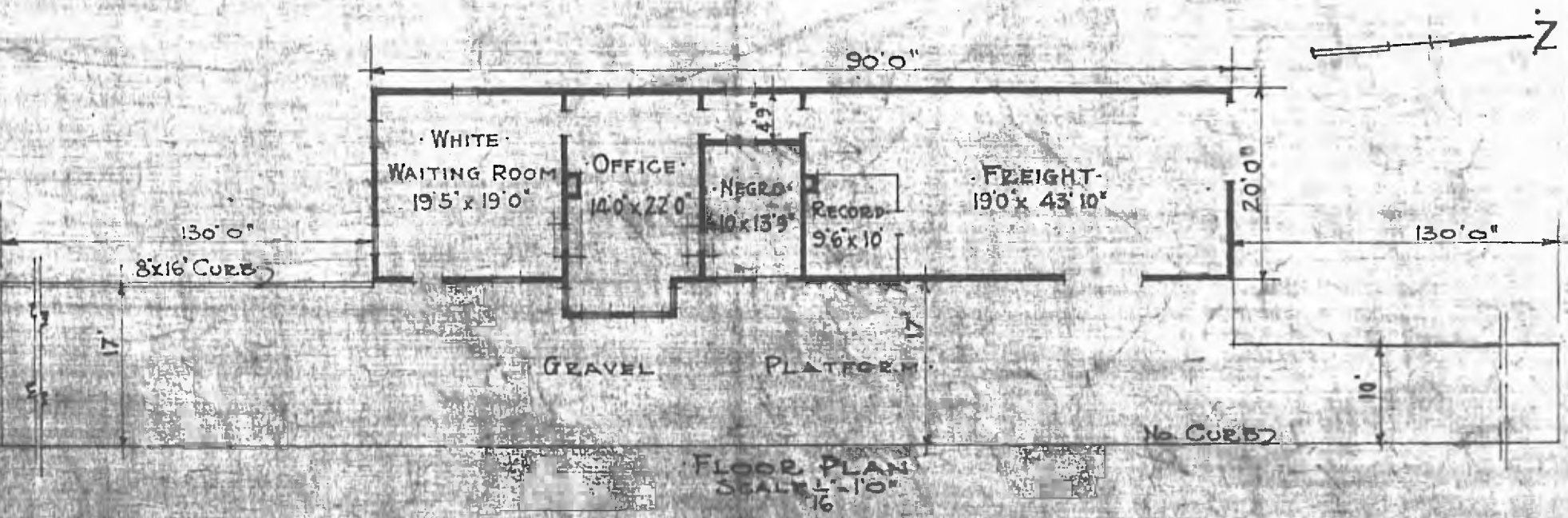

COMBINATION STATION AT
 MILL CREEK OKLA