

78.

ERECTED. 1911.  
 FOUNDATION. CONCRETE.  
 TYPE. FRAME - STANDARD.  
 WALLS. 2" x 6" STUDS.  
 ROOF. { TYPE.  
 PITCH. APPROX.  $\frac{1}{3}$  PITCH.  
 HEATING. STOVES.

FLOOR. MAPLE.  
 FINISH. { INSIDE.  $\frac{3}{4}$ " x  $\frac{3}{4}$ " V. JOINT. CEILING.  
 OUTSIDE. 6" LAP SIDING.  
 CEILING HEIGHTS. 11'4" WAITING ROOMS; T.O.; & FREIGHT ROOM.  
 LIGHTING. OIL LAMPS.  
 SANITARY FACILITIES. OUTSIDE TOILETS.

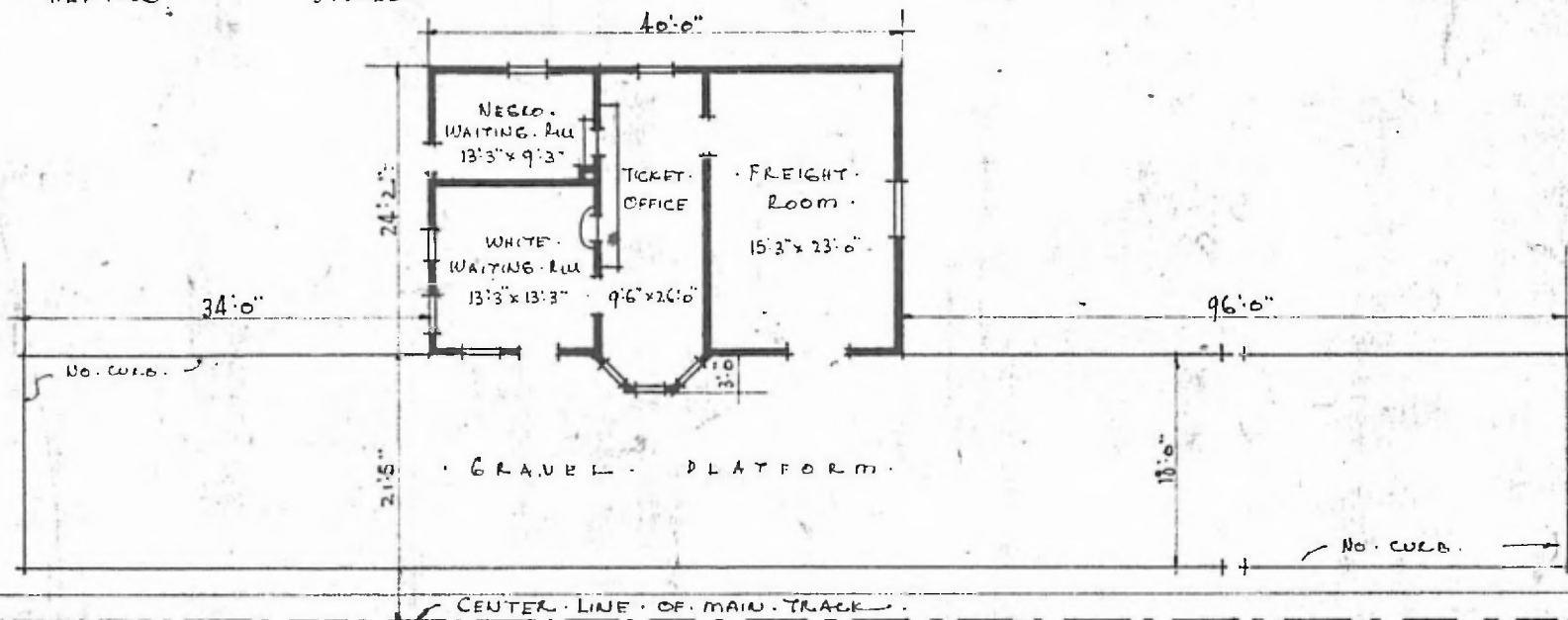

DIV. CENTRAL  
 SUB. DIV. ARTHUR  
 STA. NO 533

FLOOR PLAN  
 SCALE  $\frac{1}{16}$ " = 1'0"

COMBINATION - STATION - AT

MOYERS - OKLAHOMA

MAY. 26, 1915.