

S.W. DIV.
Creek Sub
EA 506

ERECTED. 1902. EXT. 1914.
TYPE. BRICK.
FOUNDATION. CONCRETE.
WALLS. 13" BRICK.
ROOF { TYPE. HIP. TILE.
PITCH 1/3
HEATING. STOVES.

FLOOR. CONCRETE
FINISH { INSIDE. PLASTER.
OUTSIDE. BRICK.
CEILING HEIGHT. 12' 10"
LIGHTING.
SANITARY FACILITIES. INSIDE TOILET.

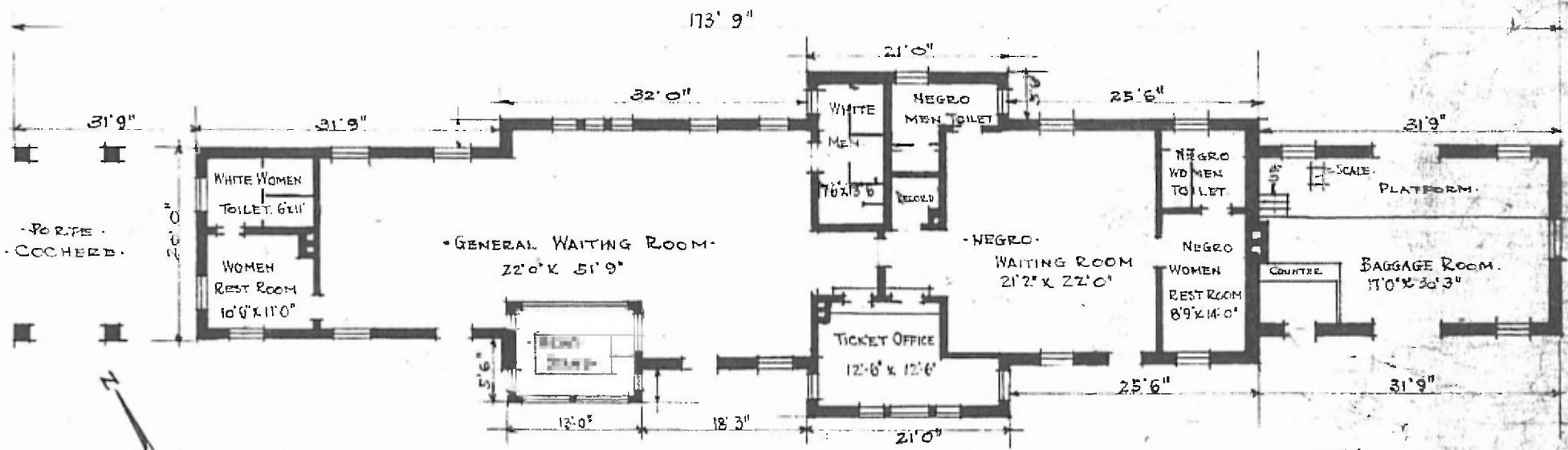

- FLOOR PLAN -
SCALE 1/16" = 1' 0"

DIV. SOUTH WESTERN
SUB. DIV. CREEK
STA. NO. EA-506
ALSO LISTED AS
DIV. RED RIVER
SUB. DIV. MUSKOGEE
STA. NO. T456

- PASSENGER STATION AT -
- MUSKOGEE, OKLA. -