

ERECTED: 1904
 TYPE: BRICK
 FOUNDATION: BRICK
 WALLS: 13" BRICK
 ROOF: TYPE HIP, SLATE.
 PITCH: 1/2
 HEATING: STOVES

FLOOR: 2" x 3/4" Y.P.
 FINISH: { INSIDE PLASTERED.
 OUTSIDE RED PRESS. RED MORTAR.
 CEILING HEIGHT: 14'2"
 LIGHTING: ELECTRIC
 SANITARY FACILITIES: INSIDE TOILETS.

DIV. SOUTH WESTERN
 SUB. DIV. OKLAHOMA

STATION NO. 6-541

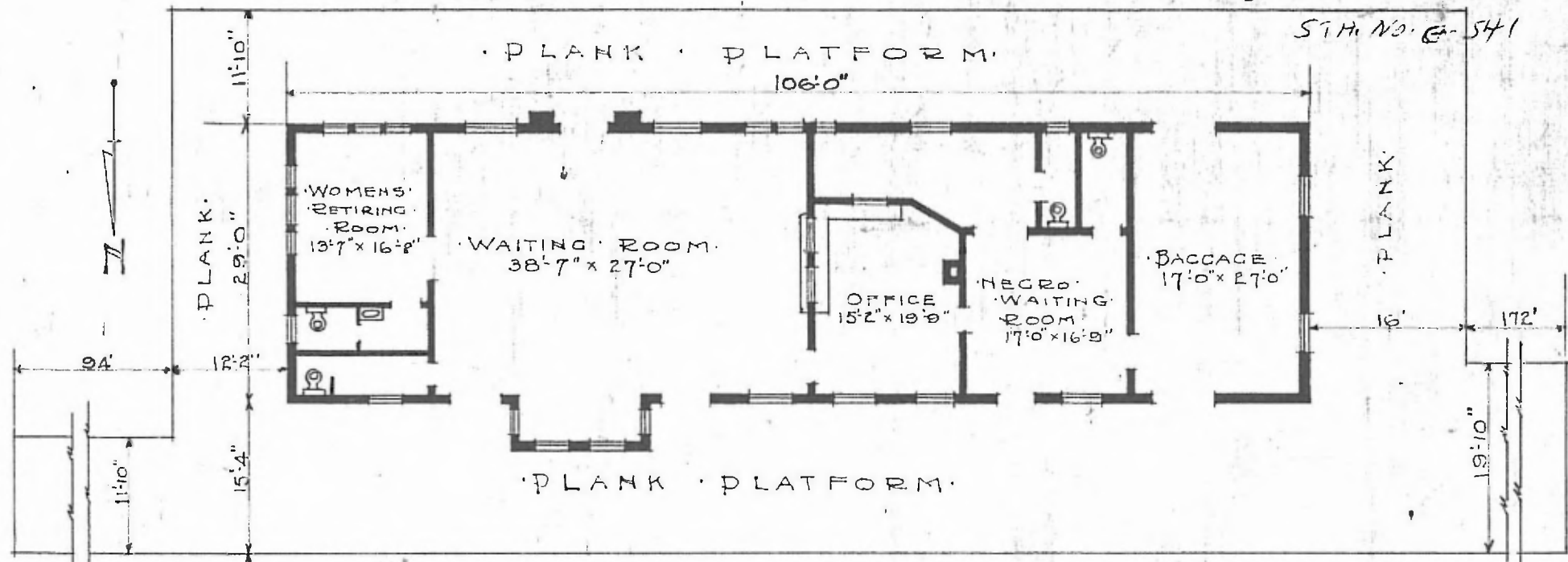

FLOOR PLAN
 SCALE 1/16" = 1'-0"

PLANK PLATFORM

PASSENGER STATION
 OKLAHOMA CITY OKLA.

SEPT. 25, 1916