

4

SW - DIV. RED RIVER  
SUB. DIV. CREEK  
STA. NO. E-462

ERECTED. 1910.  
TYPE. FRAME.  
FOUNDATION. PILE HEADS.  
WALLS. 2"x6"  
ROOF { TYPE. HIP SHINGLES.  
PITCH. 1/2  
HEATING. STOVES.

FLOOR. 2 1/4" MAPLE.  
FINISH { INSIDE. 3/4"x3 1/4" BD. CEILING  
OUTSIDE. 1"x6" DROP SIDING.  
CEILING HEIGHT. 11'3"  
LIGHTING. NAT. GAS.  
SANITARY FACILITIES. OUTSIDE TOILETS.

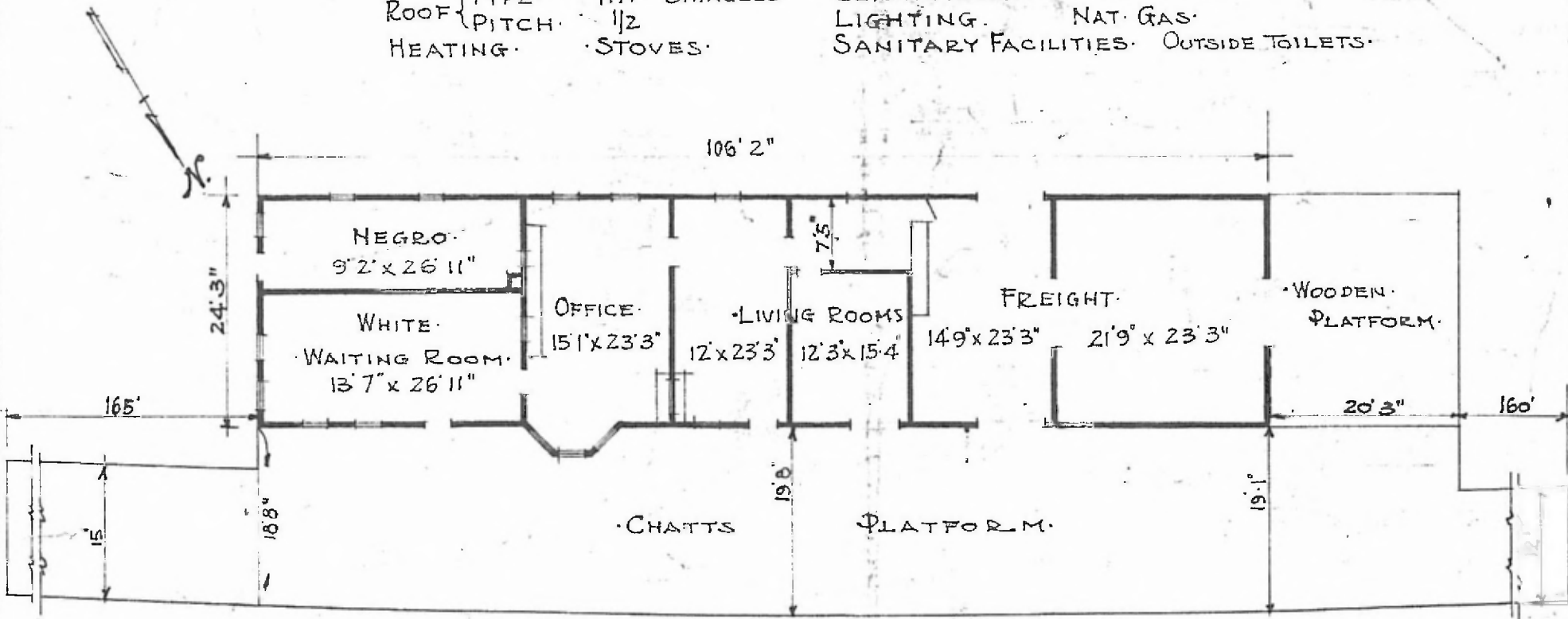

FLOOR PLAN.  
SCALE 1/16" = 10'

COMBINATION STATION AT  
PRESTON OKLA.

SEPT. 17. 1915.

P.