

ERECTED. 1911.
 TYPE. FRAME.
 FOUNDATION. CONCRETE.
 WALLS. 2"x6"
 ROOF { TYPE. GABLE. TIN SHINGLES.
 PITCH 1/2
 HEATING. STOVES.

FLOOR. 2 1/4" MAPLE.
 FINISH { INSIDE. PLASTER.
 OUTSIDE. DROP SIDING.
 CEILING HEIGHT. 12'4" FRT. 12'8"
 LIGHTING. LAMPS.
 SANITARY FACILITIES. OUTSIDE TOILETS.

SWD IV
 Sherman Sub
 E-59V

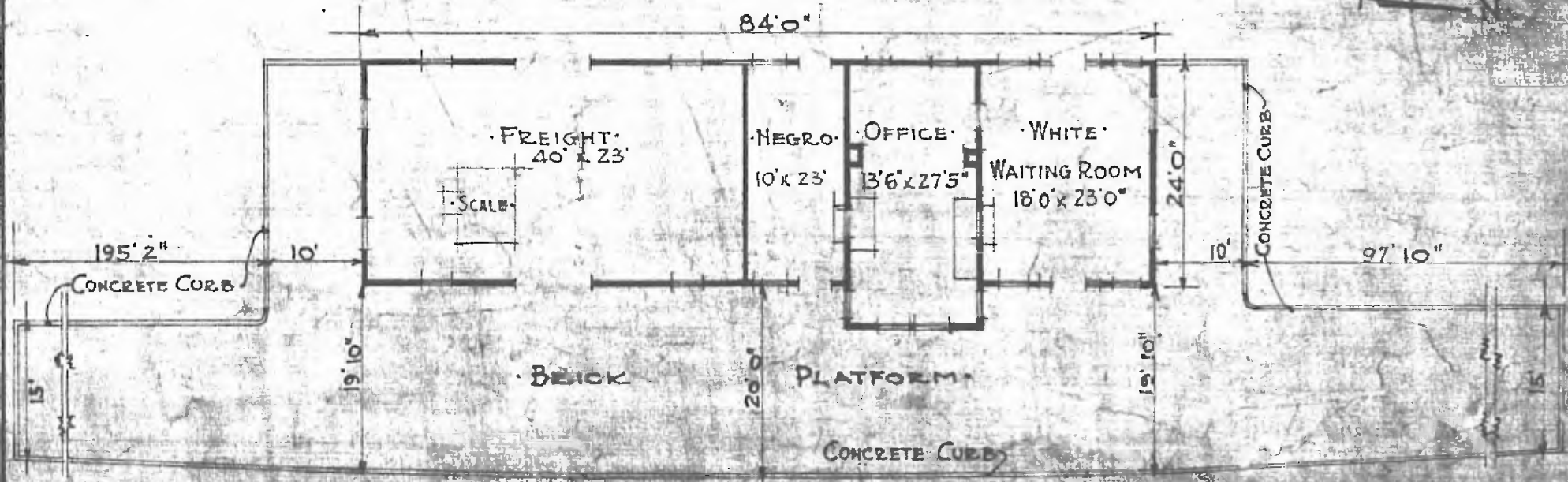

FLOOR PLAN
 SCALE 1" = 10'

COMBINATION STATION AT
 RAYIA OKLA.