

S.W. - DIV. RED RIVER  
 SUBDIV. SHERMAN 23  
 STA. 110. E 592

ERECTED: 1911.  
 TYPE: FRAME.  
 FOUNDATION: CONCRETE.  
 WALLS: 2x6"  
 ROOF: TYPE: GABLE YIN SHGS.  
       PITCH: 1/3  
 HEATING: STOVES

FLOOR: 2 1/4" MAPLE.  
 FINISH: { INSIDE: PLASTER.  
           OUTSIDE: DROP SIDING.  
 CEILING HEIGHTS: 12'4" FT. 12'8"  
 LIGHTING: LAMPS.  
 SANITARY FACILITIES: OUTSIDE TOILETS.

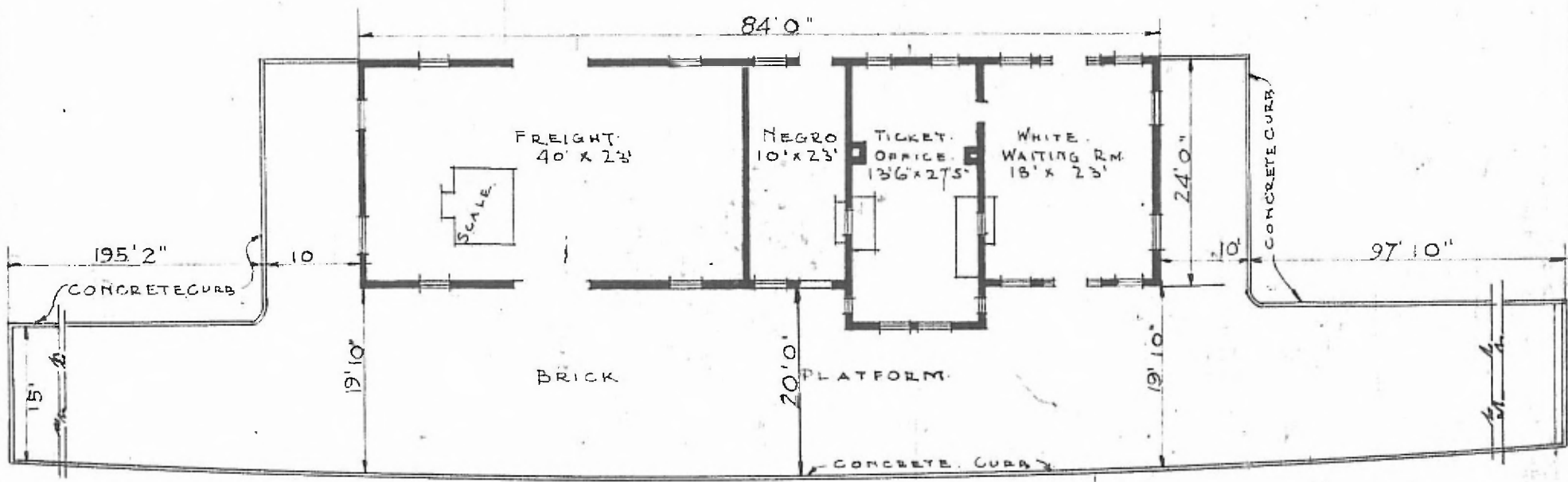

FLOOR PLAN.  
 SCALE 1/16" = 1'0"

COMBINATION STATION AT  
 RAVIA OKLA.

SEPT. 21 1915.