

Sw
Creek

ERECTED 1900.
 TYPE FRAME.
 FOUNDATION PILE HEADS.
 WALLS 2"x6"
 ROOF TYPE GABLE SHINGLE.
 PITCH 1/3
 HEATING STOVES.

FLOOR 3 1/4" Y. PINE
 INSIDE 3 1/4" Bd. CEILING.
 FINISH
 OUTSIDE BOARD & BATT.
 CEILING HEIGHT 11' 10" FRT. 14' 5"
 LIGHTING LAMPS.
 SANITARY FACILITIES OUTSIDE TOILETS.

E-532

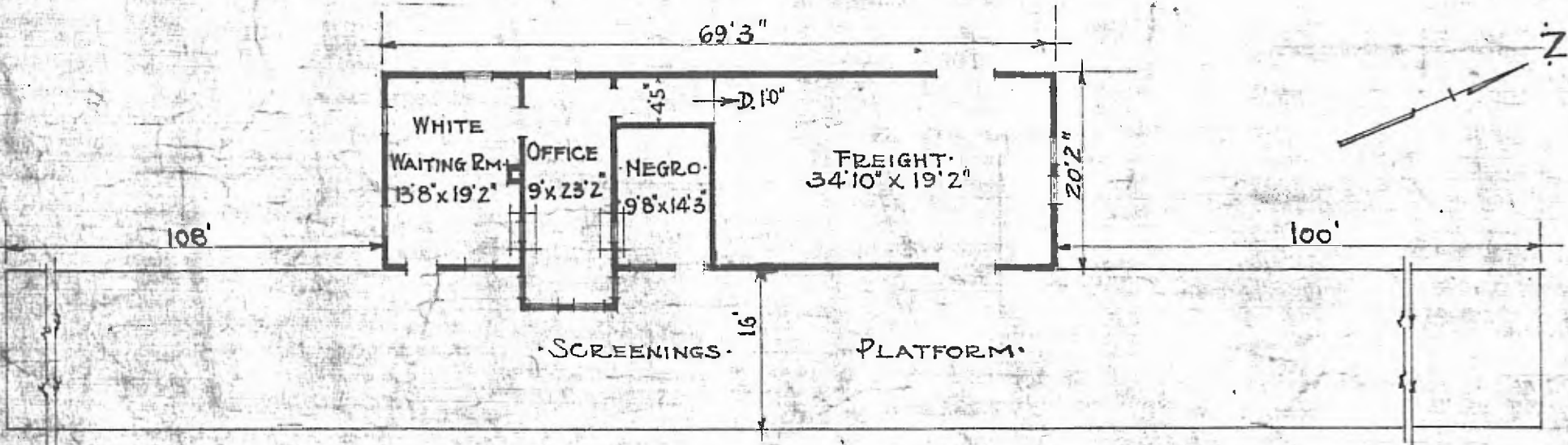

FLOOR PLAN
 SCALE 1/16" = 1'0"

COMBINATION STATION AT
 SASAKWA OKLA.

SEPT. 23 1915