

ERECTED: 1915.  
 TYPE: FRAME.  
 FOUNDATION: CONCRETE.  
 WALLS: 2" x 6"  
 ROOF: TYPE: HIP SHINGLES.  
 PITCH: 1/3.  
 HEATING: STOVES.

FLOOR: 3/4" x 3 1/4" Y. PINE.  
 FINISH: INSIDE: 3/4" Y. JOINT CEILING.  
 OUTSIDE: 1" x 6" DROP SIDING.  
 CEILING HEIGHT: 12' 2 1/2"  
 LIGHTING: LAMPS.  
 SANITARY FACILITIES: OUTSIDE TOILET.

S.W.D. W  
 Sherman Sub  
 LE 571

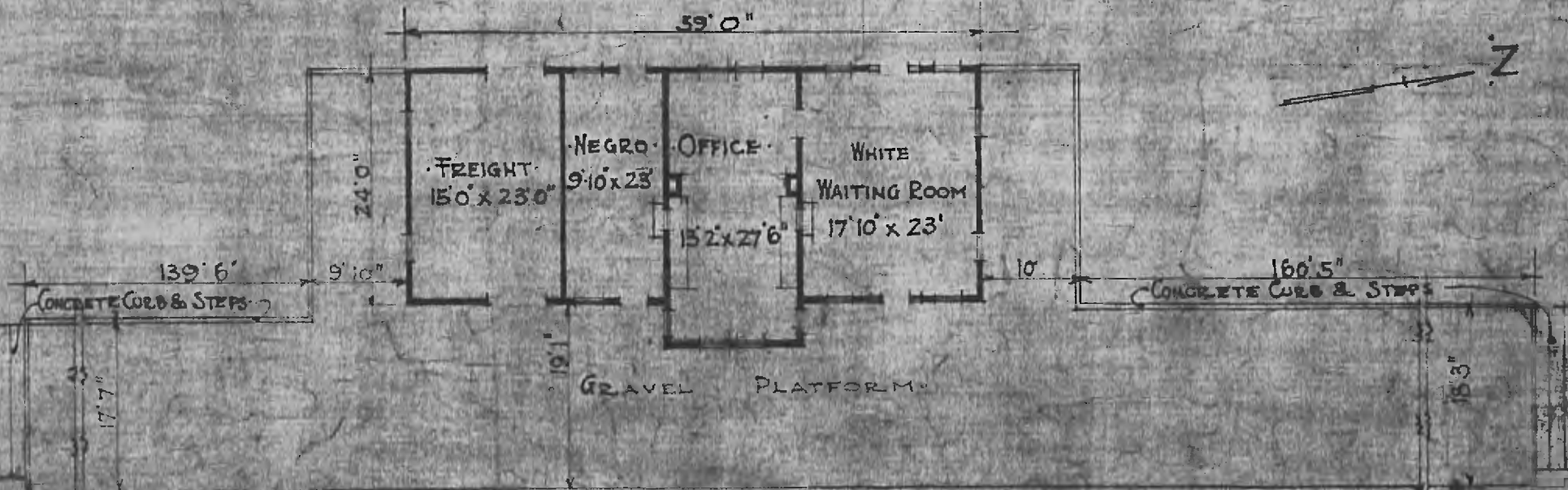

FLOOR PLAN  
 SCALE: 1/16" = 1'-0"

COMBINATION STATION AT  
 SCULLIN OKLA.