

20

S W - DIV. RED RIVER
SABIDINI SHERMAN
STA. NO. E-571

ERECTED 1915
TYPE. FRAME.
FOUNDATION CONCRETE.
WALLS. 2x6"
ROOF { TYPE. HIP SHINGLE.
DITCH. 1/3.
HEATING. STOVES.

FLOOR 3/4x3/4 Y. PINE.
FINISH { INSIDE 3/4" V JOINT CEILING
OUTSIDE 1" X 6" DROP SIDING
CEILING HEIGHTS. 12' 2 1/2"
LIGHTING. LAMPS.
SANITARY FACILITIES. OUTSIDE TOILETS.

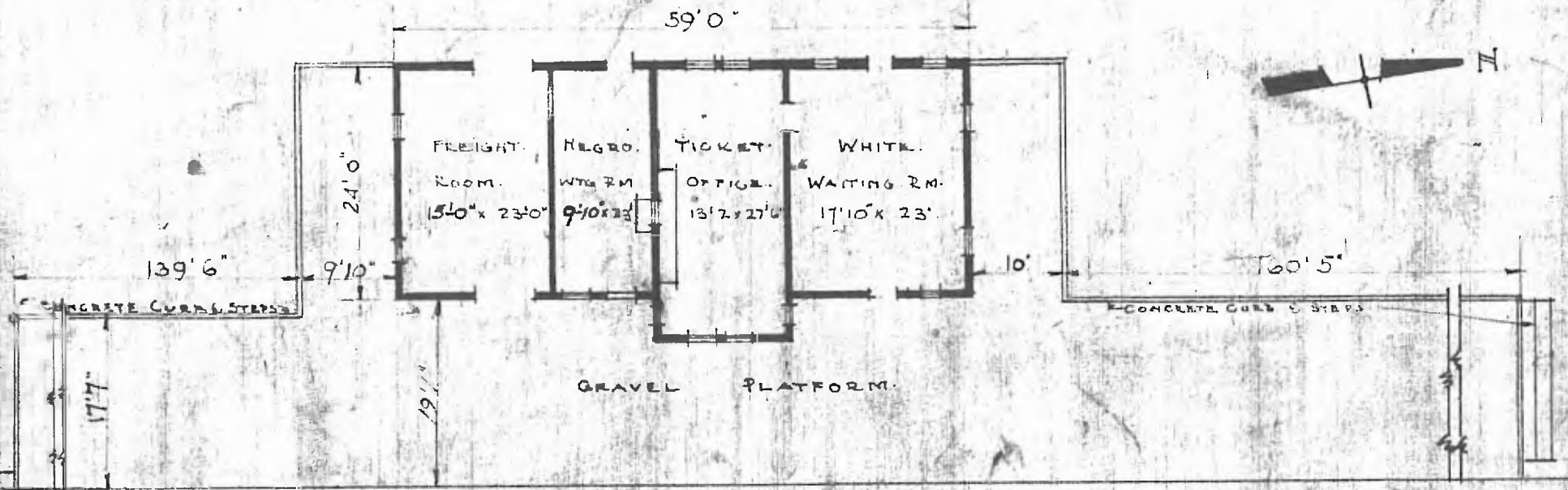

FLOOR PLAN.
SCALE 1/16" = 1'0"

COMBINATION STATION AT
SCULLIN, OKLA.

SEPT. 28, 1915