

36

DIV. SOUTH WESTERN
SUB. DIV. CATEROKEE
STA. No 6325

ERECTED 1899.
TYPE FRAME.
FOUNDATION PILE HEADS.
ROOF { TYPE GABLE SHINGLE.
PITCH 1/3
HEATING STOVES.
WALLS 2x6.

FLOOR 7/8 x 3 1/4 Y. FINE.
FINISH { INSIDE 7/8 x 3/4 M.B.
OUTSIDE DROP SIDING.
CEILING HEIGHT 13'-0" FET. 15'-0"
LIGHTING OIL LAMPS.
SANITARY FACILITIES OUTSIDE.

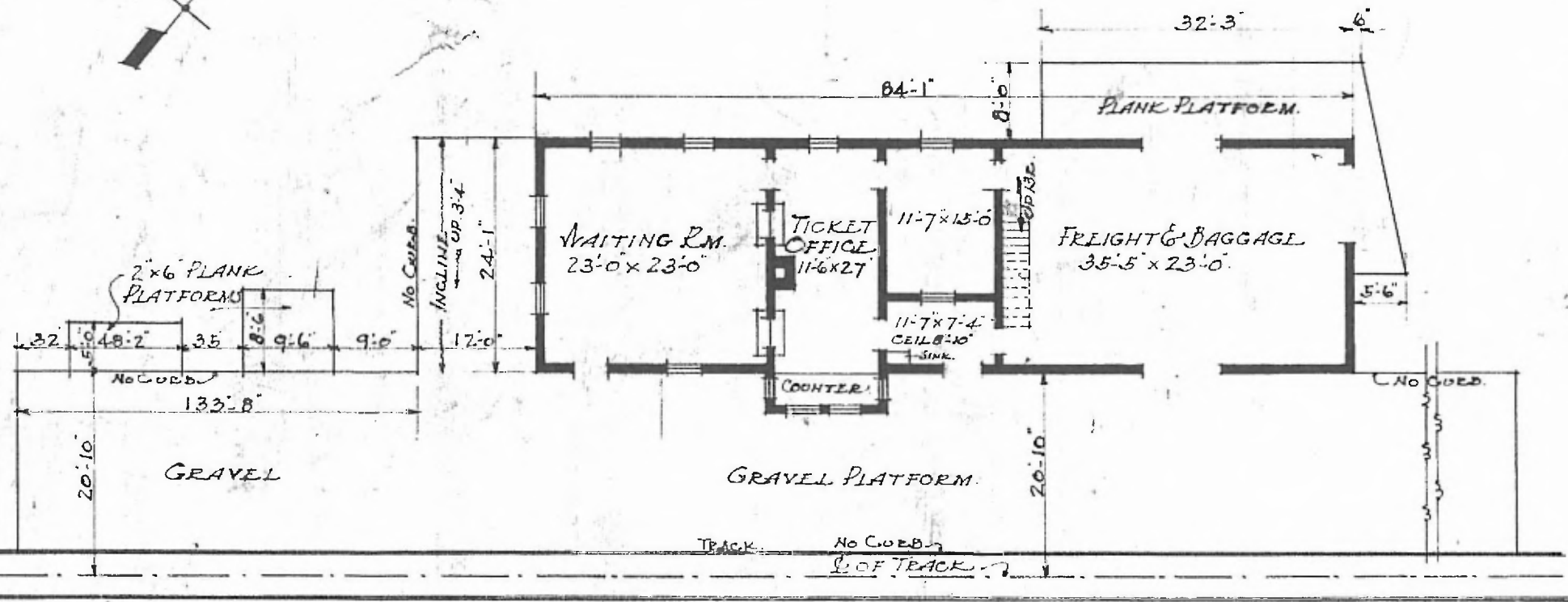
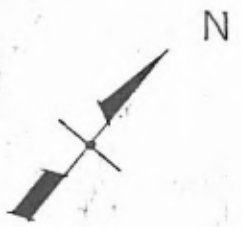

PASSENGER STATION AT
SENECA, OKLA.

FLOOR PLAN.
SCALE 1/16" = 1'-0"

JULY 30 1916.