

88

ERECTED: 1910.  
 TYPE: BRICK.  
 FOUNDATION: CONCRETE.  
 ROOF: TYPE: HIP TILE.  
 PITCH: APPROX.  $\frac{1}{3}$  &  $\frac{1}{4}$ .  
 WALLS: BRICK.  
 HEATING: STEAM.

FLOOR: 1  
 FINISH: INSIDE.  
 OUTSIDE.  
 CEILING: HEIGHT:  
 LIGHTING:  
 SANITARY FACILITIES: INSIDE.

TILE & CONCRETE:  
 PLASTER:  
 BRICK:  
 15'0" EXPOSED 14 3/4"  
 ELECTRIC:

DIV. SOUTHWESTERN  
 SUB. DIV. CHICAGO  
 STA No K744

S

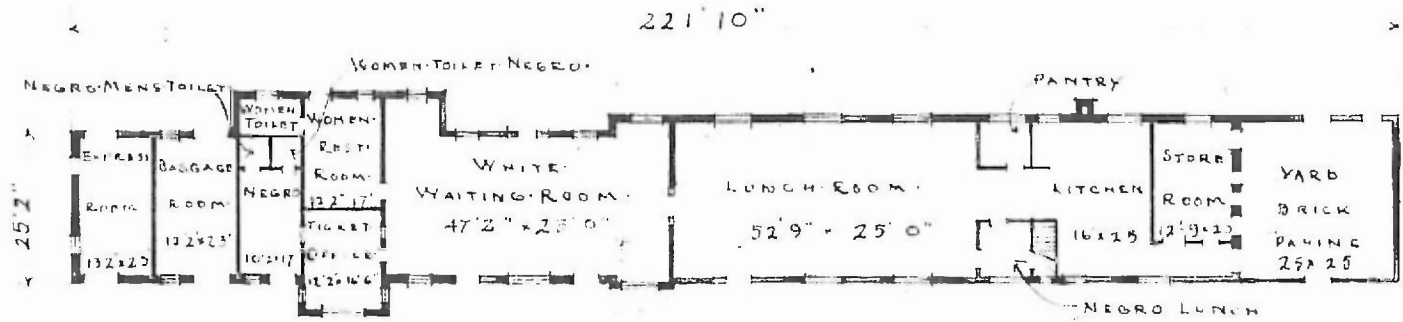

- FLOOR PLAN -  
 SCALE  $\frac{1}{32} = 1'0"$

PASSENGER STATION  
 AND  
 EATING HOUSE  
 SNYDER OKLA.



JULY 1 1911