

ERECTED 1898  
 TYPE FRAME  
 FOUNDATION WOOD BLOCKS  
 WALLS 2" x 6"  
 ROOF (TYPE: GABLE, SHINGLES.  
 PITCH: 1/3)  
 HEATING STOVES

FLOOR 3/4 x 3/4" Y.P.  
 FINISH (INSIDE: 3/4 x 3/4" M.G.B.  
 OUTSIDE: BOARDS & BATTENS  
 CEILING HEIGHT 11'3"  
 LIGHTING OIL LAMPS  
 SANITARY FACILITIES OUTSIDE TOILETS

DIV. SOUTHWESTERN  
 SUB. DIV. OKLAHOMA  
 STA. NO. E 531

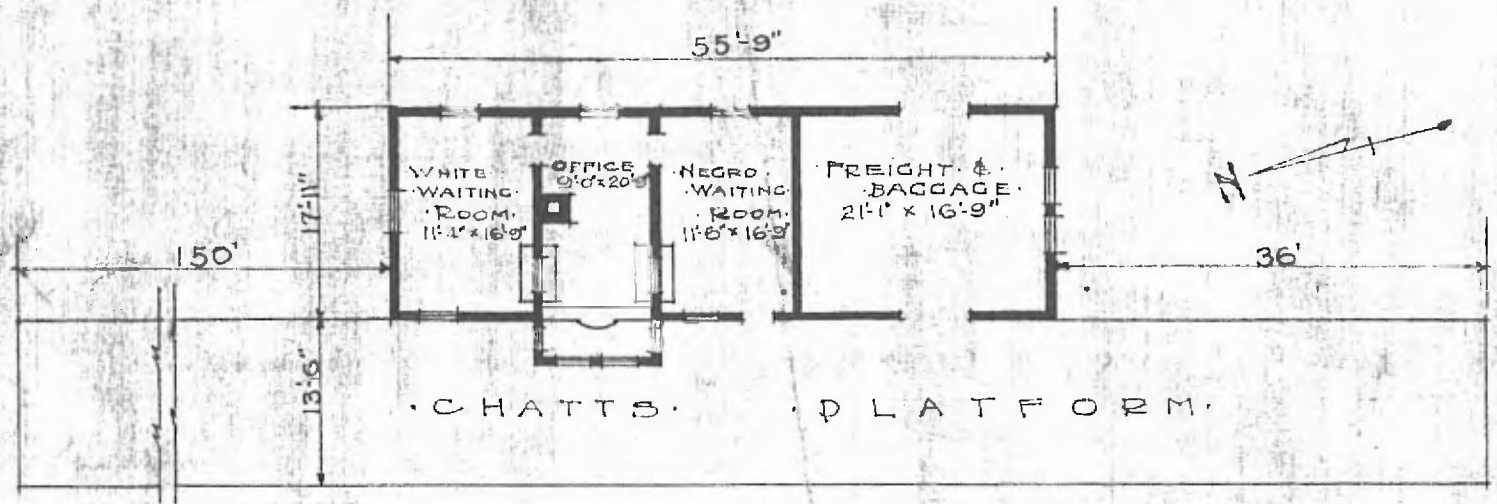

FLOOR PLAN  
 SCALE 1/16" = 10"

COMBINATION STATION  
 SPENCER OKLA.

OCT. 10, 1916.