

ERECTED - 1912
 TYPE - BRICK
 FOUNDATION - CONCRETE
 WALLS - 13" BRICK
 ROOF { TYPE - HIP - METAL TILE
 PITCH - APPROX 1/3 PITCH
 HEATING - STOVES

FLOOR - 7/8" x 3 1/4" YELLOW PINE & CONCRETE
 FINISH - { INSIDE - PLASTER & BRICK
 OUTSIDE - BRICK
 CEILING HEIGHT - 12' 0"
 LIGHTING - ELECTRIC LIGHT
 SANITARY FACILITIES

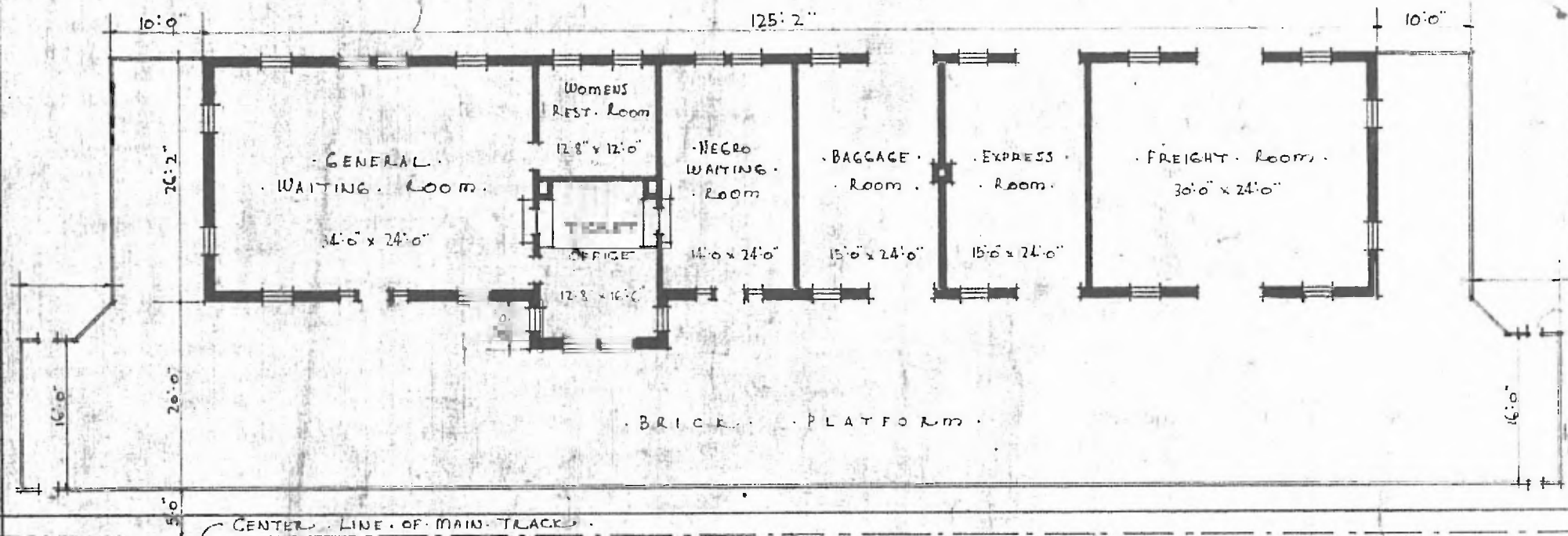

FLOOR PLAN
 SCALE 1/16" = 1'0"
 SW - DIV. RED RIVER
 SUB. DIV. MUSKOGEE
 STA. No. Y 421

COMBINATION - STATION - AT -

TAHLEQUAH - OKLA



OCTOBER . 2 . 1916 .