

40

ERECTED 1912  
 TYPE FRAME  
 FOUNDATION CONCRETE  
 ROOF { TYPE HIP SHINGLE  
       PITCH 1/3  
 WALLS 2"x6"  
 HEATING STOVES

FLOOR 2 1/4 MAPLE  
 FINISH { INSIDE V JOINT CEILING  
           OUTSIDE COVE SIDING  
 CEILING HEIGHT 12'-0"  
 LIGHTING OIL LAMPS  
 SANITARY FACILITIES OUTSIDE

DIV. SOUTHWESTERN  
 SUB. DIV. CHEROKEE  
 STA. NO. G 354

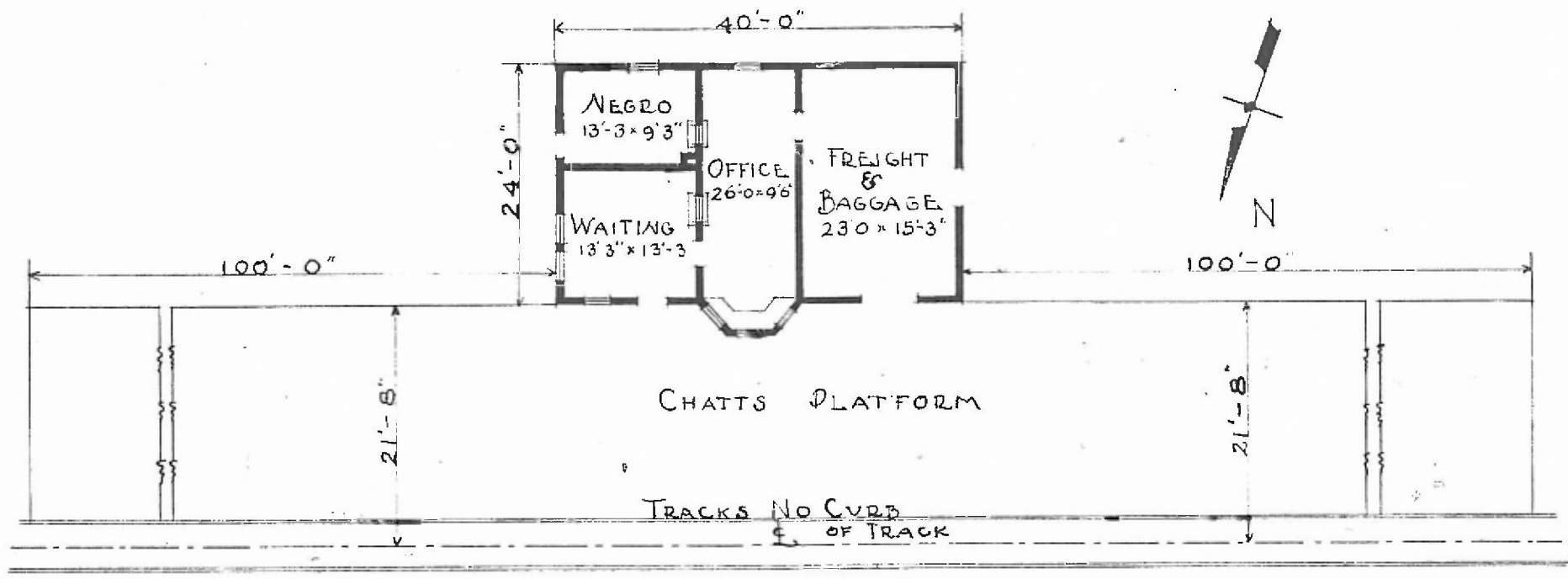

FLOOR PLAN  
 SCALE 1/16" = 1'-0"

PASSENGER STATION AT  
 TODD OKLA.

AUGUST 19, 1916.