

ERECTED. 1900.
 TYPE. FRAME.
 FOUNDATION. PILE HEAD.
 WALLS. 2' x 6"
 ROOF { TYPE. HIP SHINGLES.
 PITCH. 1/3
 HEATING. STOVES.

FLOOR. 3 1/2" Y. PINE.
 FINISH { INSIDE. 3/4" Bd. CEILING.
 OUTSIDE. BOARDS & BATTS.
 CEILING HEIGHT. 11' 7"
 LIGHTING. LAMPS.
 SANITARY FACILITIES. OUTSIDE TOILETS.

SW DIV
 Sherman Sub
 E 586

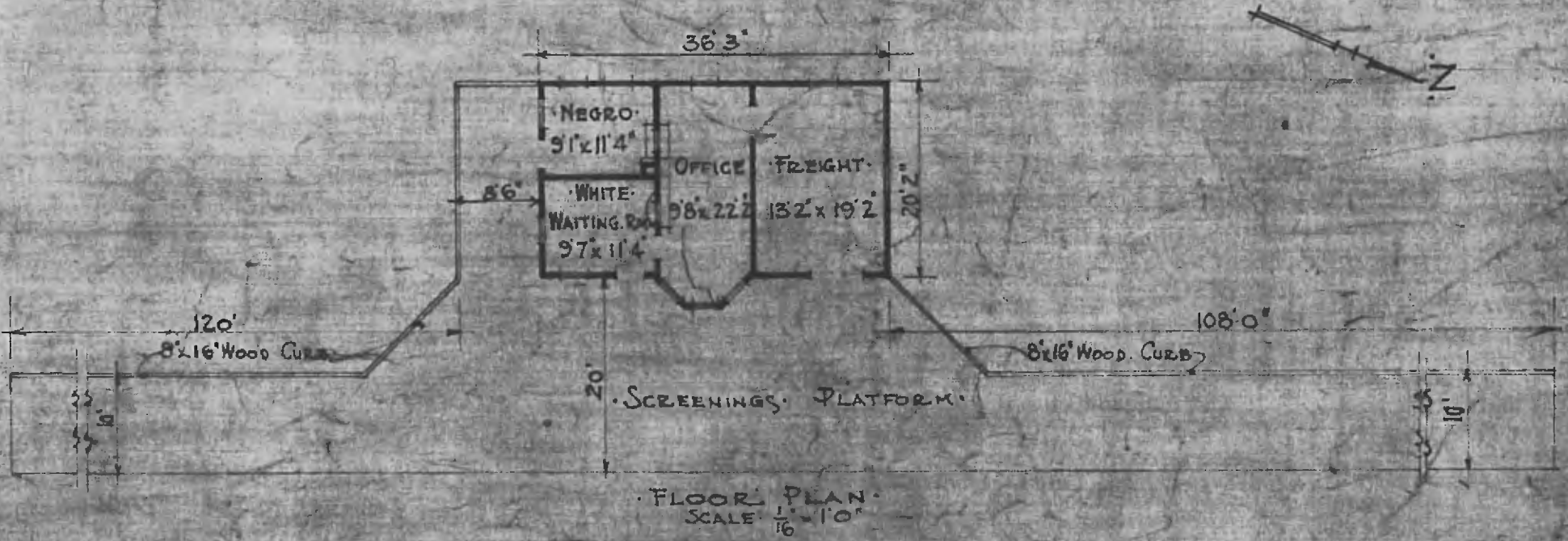

COMBINATION STATION AT
 TROY OKLA.

SEPT. 29 - 1915.