

ERECTED. 1900.
 TYPE. FRAME
 FOUNDATION. PILE HEADS.
 WALLS. 2" x 6"
 ROOF { TYPE. HIP SHINGLES.
 PITCH. 1/3
 HEATING. STOVES.

FLOOR. 3/4" L. PINE.
 FINISH { INSIDE. 3/4" BD. CEILING.
 OUTSIDE. BOARD. & BATTIS.
 CEILING HEIGHTS 11'
 LIGHTING. LAMPS.
 SANITARY FACILITIES. OUTSIDE TOILETS.

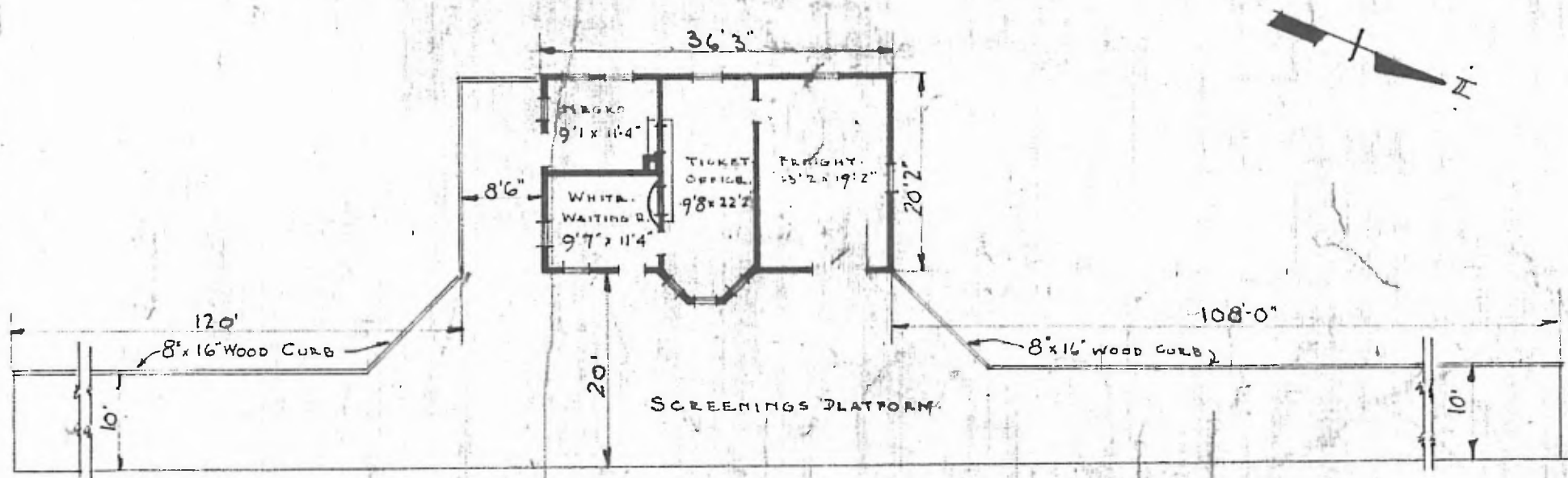

FLOOR PLAN.
 SCALE 1/16" = 1'-0"

COMBINATION STATION AT
 TROY OKLA.

SEPT. 29, 1915.