

ERECTED 1906. ALTERATIONS 1919.

TYPE: BRICK.
 FOUNDATION: CONCRETE.
 WALLS: 13" BRICK.
 ROOF: { TYPE: HIP ROOF. RED TILE.
 PITCH: APPROX. 1/3.
 HEATING: STEAM.

FLOOR: FINISH: { INSIDE: PLASTER.
 OUTSIDE: BRICK.
 CEILING HEIGHT: 13'0".
 LIGHTING: ELECTRIC.
 SANITARY FACILITIES: INSIDE TOILET.

DIV. SOUTH WESTERN
 SUB. DIV. CHEROKEE
 STA. NO. G. 424

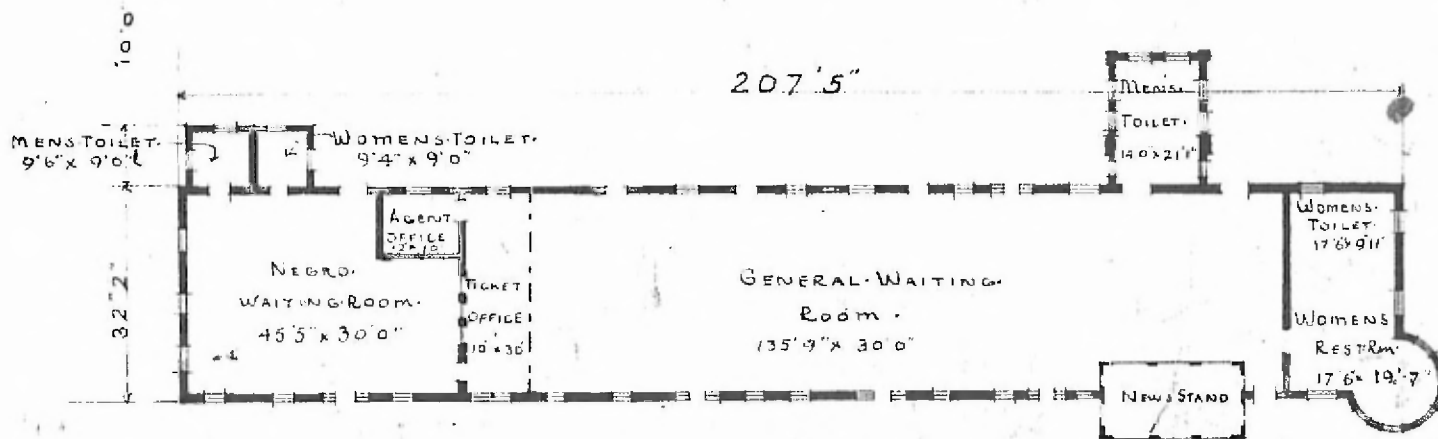

- FLOOR PLAN -

SCALE 3/32" = 1'0"

PASSENGER STATION AT
TULSA, OKLA.

APRIL 17, 1919.