

ERECTOR. 1918
 TYPE. FRAME.
 FOUNDATION. CONCRETE.
 WALLS. 2"x6"
 ROOF { TYPE. HIP, SHINGLE
 PITCH. 1/3
 HEATING. STOVES

FLOOR. 3/4" x 3 1/4" Y. PINE.
 FINISH { INSIDE. 3/4" x 3 1/4" BD. CEILING.
 OUTSIDE DROP SIDING
 CEILING HEIGHT. 11'-4"
 LIGHTING. LAMPS.
 SANITARY FACILITIES. OUTSIDE TOILET

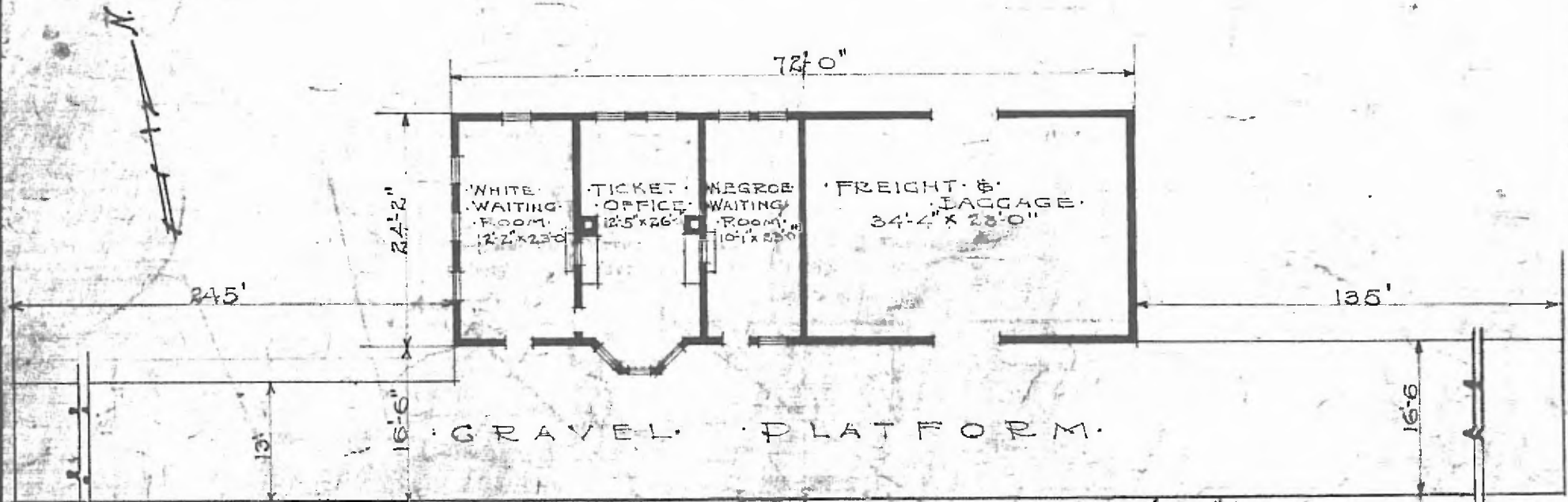

FLOOR PLAN.
 SCALE 1/16" = 1'0"

DIV. CENTRAL
 SUB. DIV. ARTHUR
 STA. NO. 501

COMBINATION STATION AT
 TUSKAHOMA OKLA.

SEPT 3, 1918.