

ERECTED
TYPE
FOUNDATION
ROOF TYPE
PITCH
WALLS
HEATING

1910
FRAME
PILE HEADS
GABLE SHINGLE
1/2
2"x6"
STOVES

FLOOR
FINISH { INSIDE
 { OUTSIDE
CEILING HEIGHT
LIGHTING
SANITARY FACILITIES

2 1/4 MAPLE
7/8" x 3 1/2" V. JOINT CEILING
BOARDS & BATTYS - DROP SIDING
11'3" W.R.; T.O.; 11'4" F.R. (OPEN)
OIL LAMPS
OUTSIDE TOILETS
DIV. SOUTHWESTERN
SOB. DIV. CHA. ROCKIER
STA. NO. 6404

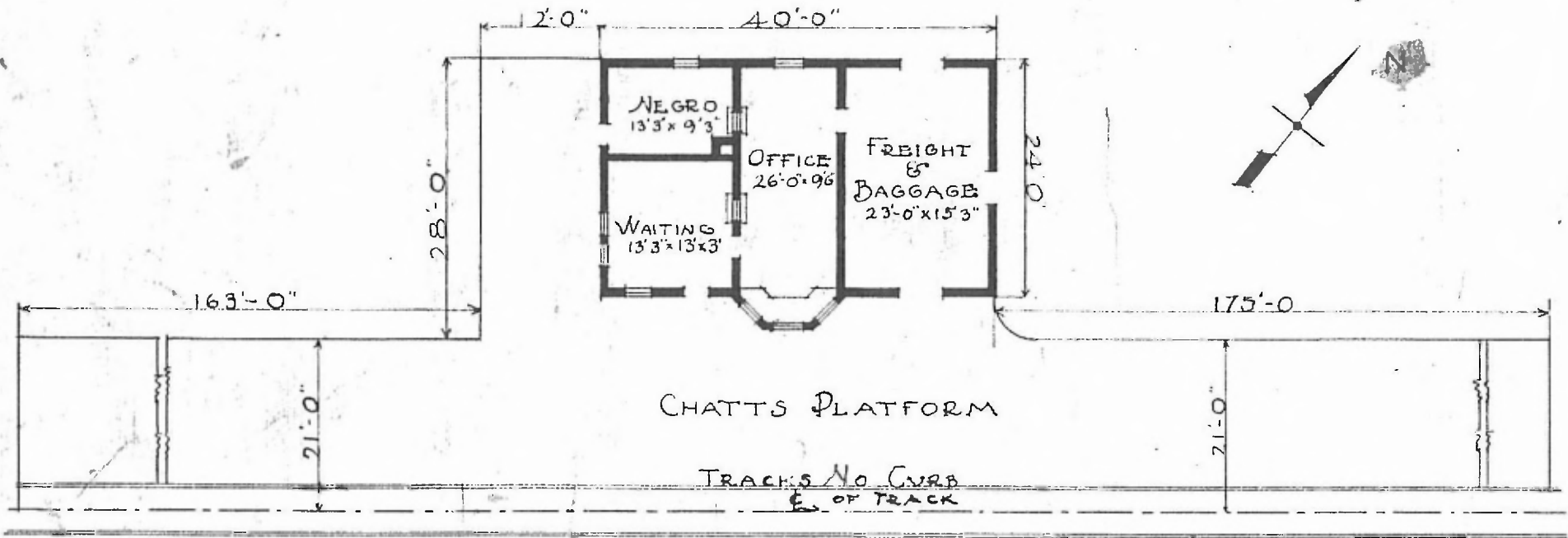

FLOOR PLAN -
SCALE 1/16" = 1'-0"

PASSENGER STATION AT
VERDIGRIS OKLA.

OCTOBER 2, 1915.