

DIV. SOUTH WESTERN  
SUB-DIV. CHEROKEE  
STATION NO. G-360

ERECTED 1905.  
TYPE BRICK  
FOUNDATION CONCRETE  
WALLS 13" BRICK.  
ROOF TYPE HIP.  
PITCH 1/3  
HEATING STOVES.

FLOOR 3/8 x 3 1/2" MAPLE.  
FINISH { INSIDE PLASTER. WOOD CEILING.  
          { OUTSIDE BRICK.  
CEILING HEIGHT 13'-0"  
LIGHTING ELECTRIC LIGHTS.  
SANITARY FACILITIES INSIDE.

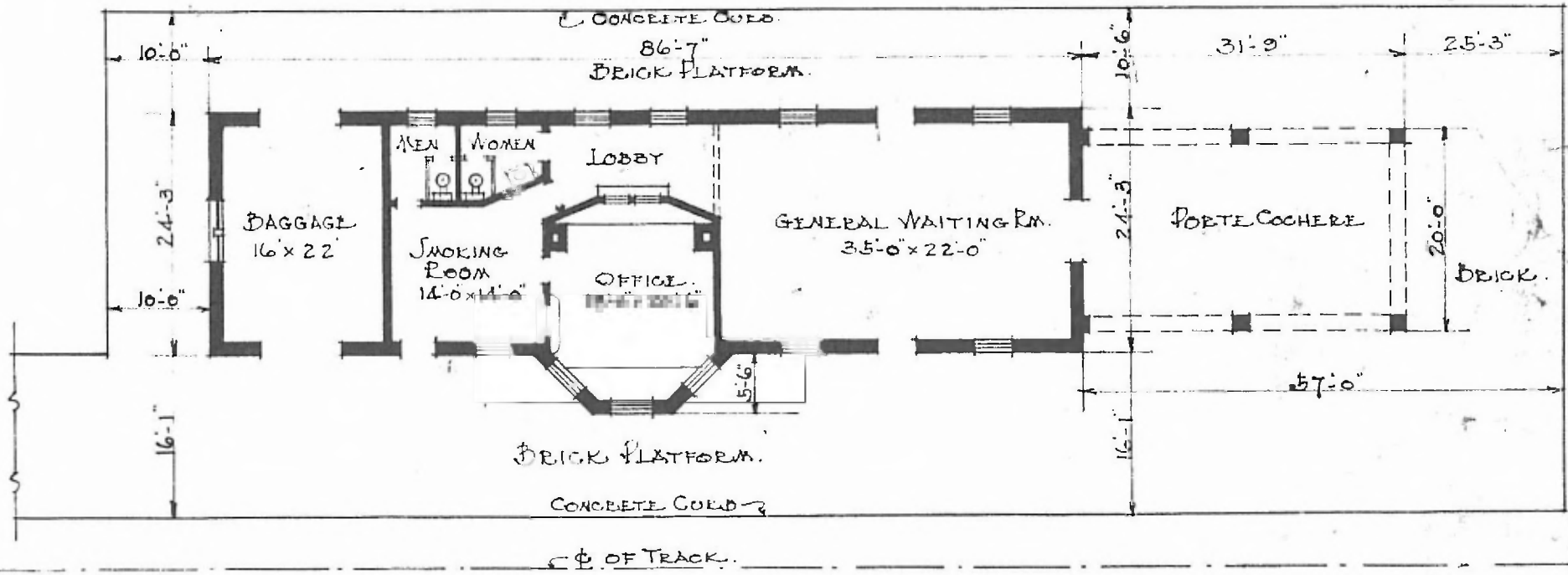
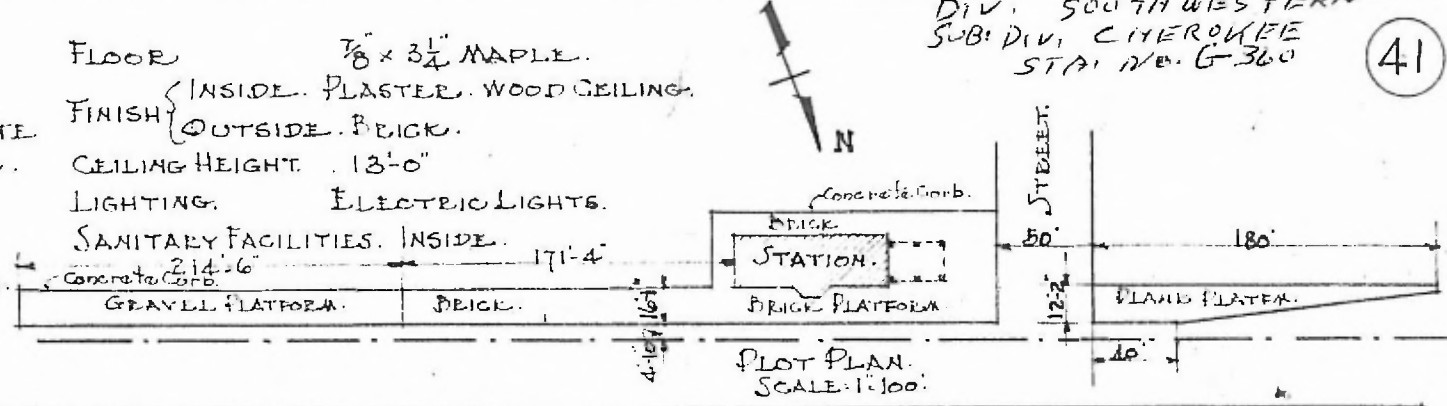

FLOOR PLAN SCALE: 1/16" = 1'-0"

PASSENGER STATION AT VINITA, OKLA.

AUG. 7, 1916.