

ERECTED. 1900.
 TYPE. FRAME.
 FOUNDATION. PILE HEADS.
 WALLS 2'x4'
 ROOF { TYPE. HIP-SHINGLES.
 PITCH. 1/3
 HEATING. STOVES.

FLOOR. 3/4" x 3 1/4" Y. PINE.
 FINISH { INSIDE. 3/4" x 3 1/4" Bd. CEILING.
 OUTSIDE. BOARD & BATTIS.
 CEILING HEIGHT. 11'6" FT. RM. 12'0"
 LIGHTING. LAMPS.
 SANITARY FACILITIES. OUTSIDE TOILET.

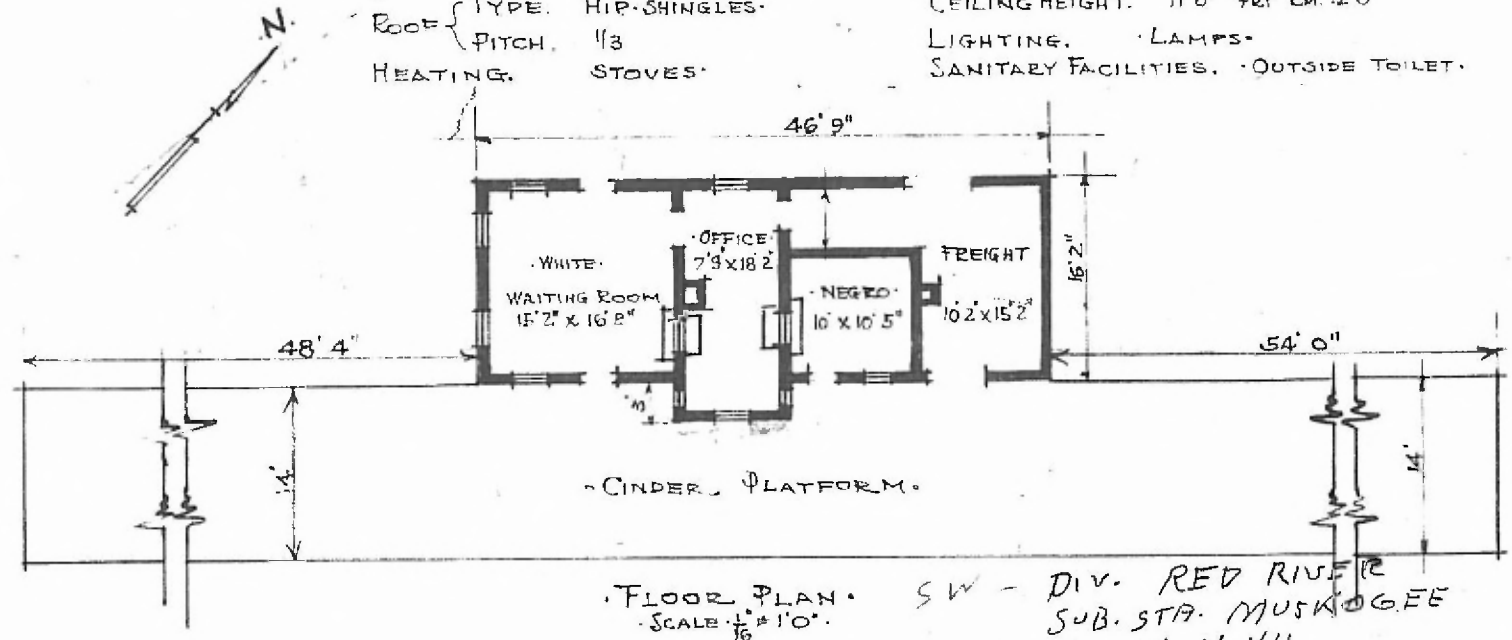

FLOOR PLAN.
 SCALE 1/16" = 1'0"

SW - DIV. RED RIVER
 SUB. STA. MUSKOGEE
 STA. No Y 411

COMBINATION STATION AT
 WELLING OKLA.

Aug 30. 1915.