

ERECTED 1898
 TYPE FRAME
 FOUNDATION PILE HEADS
 WALLS 2" x 6"
 ROOF TYPE GABLE, SHINGLES
 PITCH $\frac{3}{4}$
 HEATING STOVES

FLOOR $\frac{3}{4}$ " x $3\frac{1}{4}$ " Y. P.
 FINISH { INSIDE
 { OUTSIDE
 CEILING HEIGHT 11'-10"
 LIGHTING OIL LAMPS
 SANITARY FACILITIES OUTSIDE TOILETS

DIV. SOUTH WESTERN
 SUB DIV. OKLAHOMA
 STA. NO. G 506 (65)

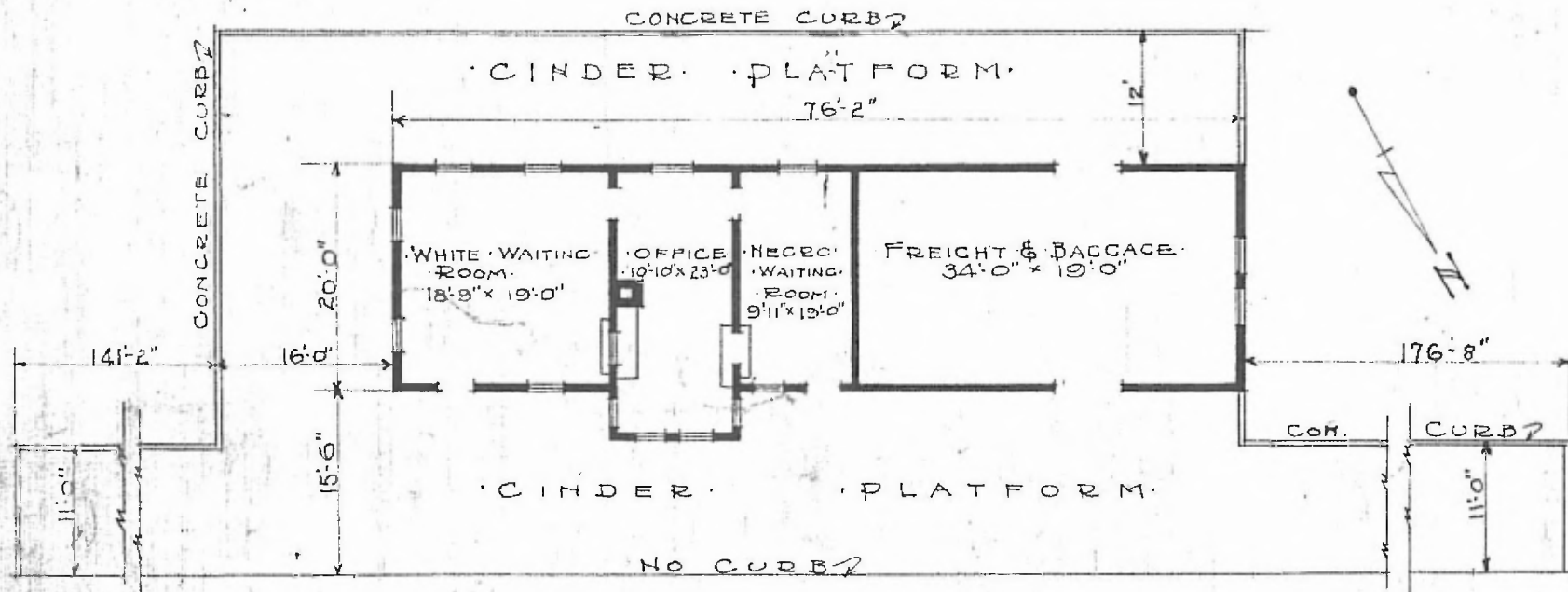

FLOOR PLAN
 SCALE $\frac{1}{16}$ " = 1'-0"

JULY 12, 1916.

COMBINATION STATION
 WELLSTON OKLA.