

46

ERECTED. 1902
 TYPE. FRAME
 FOUNDATION. PILE HEADS
 WALLS. 2"x6"
 ROOF { TYPE HIP SHINGLES
 PITCH 1/2
 HEATING. STOVES

FLOOR 3/4" x 3 1/4" Y. PINE
 INSIDE V JOINT BD. CEILING
 FINISH. { OUTSIDE 1/2" X 6. BEVEL SPG & BOARDS & BATT.
 CEILING HEIGHT 13'-10 1/2" FT. BM 11'-11"
 LIGHTING. ELECTRIC 2 WIRE 110 A.C.
 SANITARY FACILITIES. OUTSIDE TOILETS.

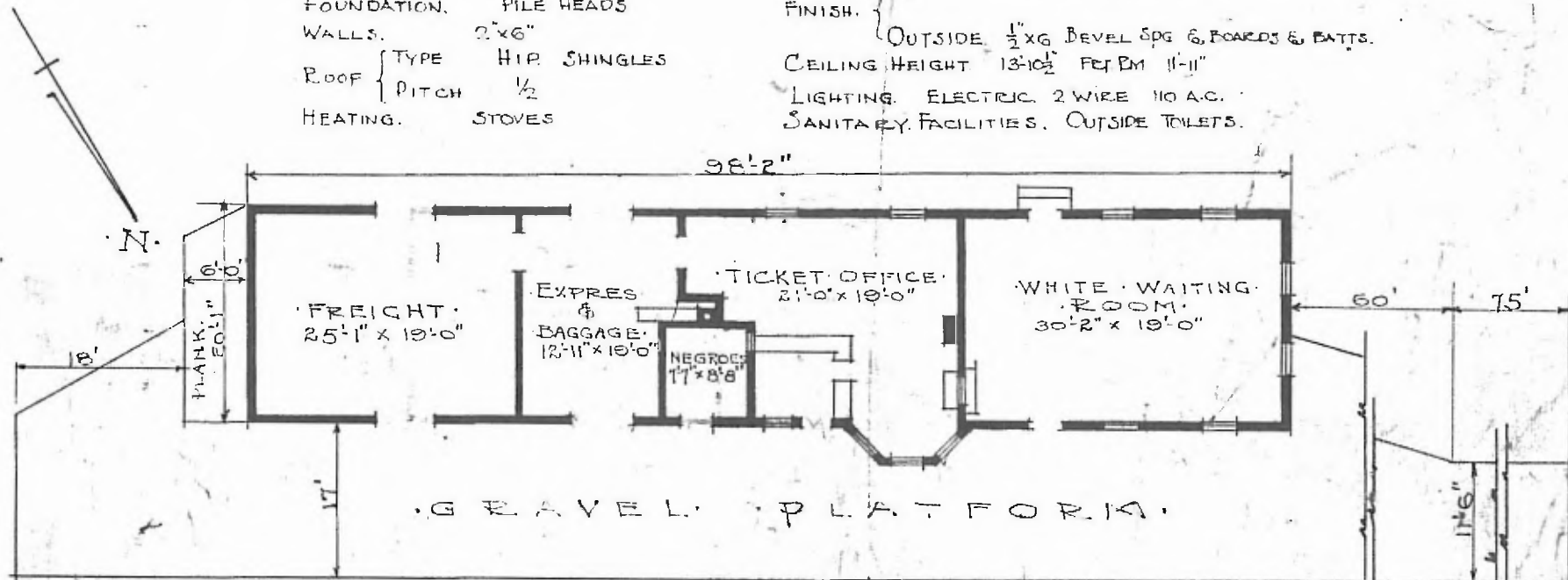

FLOOR PLAN.
 SCALE 1/16" = 1'-0"

SW-DIV. RED RIVER
 SUB-DIV. MUSKOGEE
 STA. NO. Y384

COMBINATION STATION AT
 WESTVILLE, OKLA.

SEPT. 2, 1919.