

ERECTED 1874  
 TYPE FRAME  
 FOUNDATION PILE HEADS.  
 WALLS 2 x 4  
 ROOF { TYPE - GABLE - WOOD SHINGLES.  
 PITCH - 1/3  
 HEATING STOVES.

FLOOR FINISH { INSIDE -  
 OUTSIDE -  
 CEILING HEIGHT 11'-4"  
 LIGHTING OIL LAMPS.  
 SANITARY FACILITIES - OUTSIDE TOILETS.

DIV. SOUTH WESTERN  
 SUB-DIV. CHEROKEE  
 STR. NO. 6333

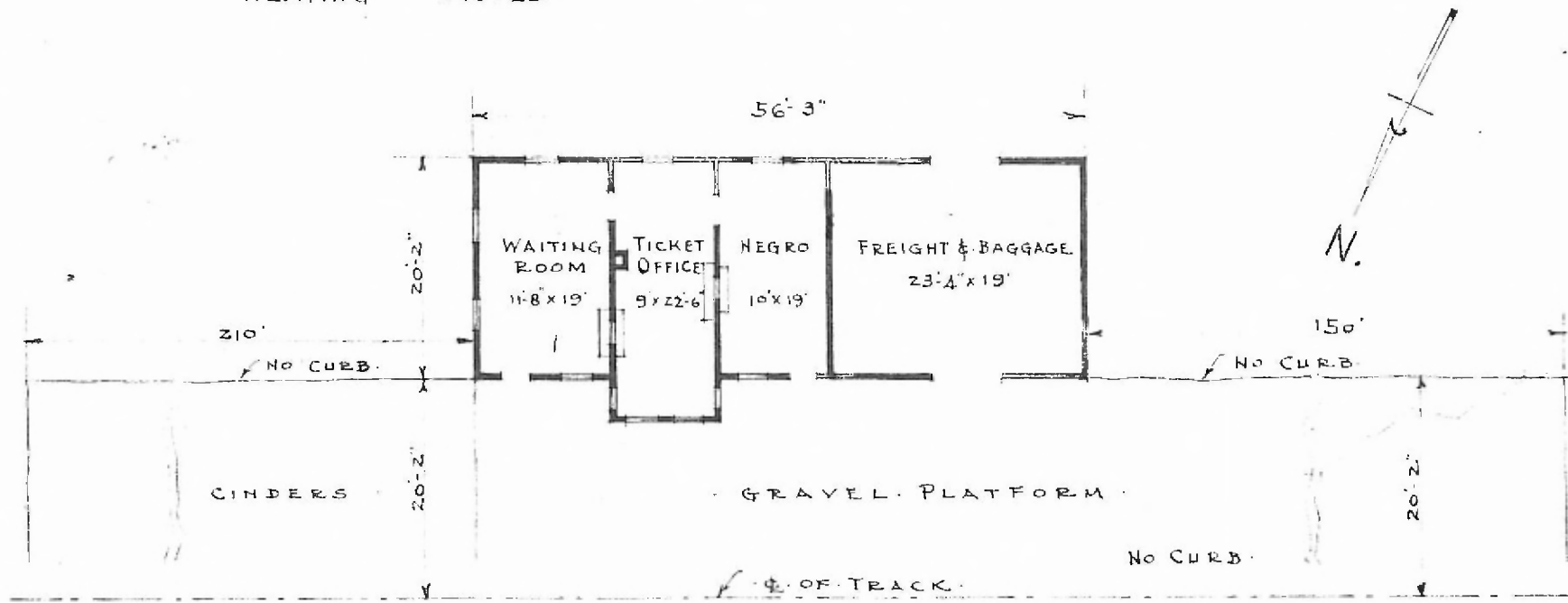

FLOOR PLAN  
 SCALE: 1/16" = 1'-0"

PASSENGER STATION AT  
 WYANDOTTE OKLA.